

Catalogue Fittings

April 2010

Pressure Piping Systems
for Water Applications



PVC-U fittings solvent cement jointing

Metric range

Elbow 90° PVC-U metric

• (*) Traded items

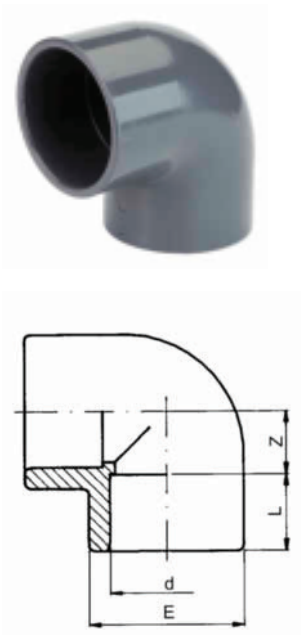

d [mm]	d [inch]	PN	Code	SP	GP	kg	L [mm]	Z [mm]	E [mm]
16		16	RV0GOI160	80	320	0.010	14.0	9	22
20		16	RV0GOI200	80	160	0.015	16.0	11	26
25		16	RV0GOI250	80	160	0.025	19.0	14	32
32		16	RV0GOI320	10	80	0.040	22.0	17	40
40		16	RV0GOI400	65	-	0.095	26.0	21	51
50		16	RV0GOI500	80	-	0.120	31.0	26	61
63		16	RV0GOI630	40	-	0.206	38.0	33	75
75	2 ½	16	RV0GOI750	50	-	0.386	44.0	39	89
90		16	RV0GOI900	30	-	0.622	51.0	47	106
110		16	RV0GOI910	17	-	1.078	61.0	57	129
125		16	RV0GOI920	12	-	1.390	69.0	66	145
140	5	16	RV0GOI930	8	-	2.050	76.0	72	163
160		16	RV0GOI940	5	-	3.105	86.0	82	190
200		16	RV0GOI960	28	-	4.800	106.0	102	228
225		10	RV0GOI970	18	-	6.600	119.0	115	255
* 250		10	RV0GOI980	1	-	12.100	131.0	188	286
* 315		10	RV0GOI991	1	-	23.500	164.0	239	358

PF 2 01 950 010

Elbow 90° M/F PVC-U metric

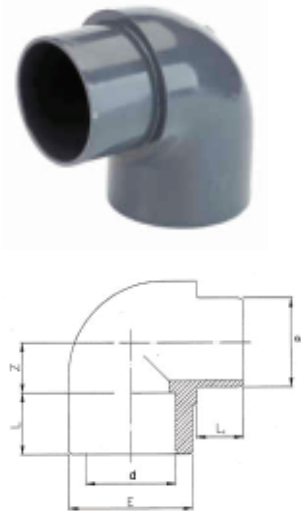

d [mm]	PN	Code	SP	GP	kg	L [mm]	L1 [mm]	Z [mm]	E [mm]
50	16	RV0GPI500	75	-	0.155	31	31	26	61
63	16	RV0GPI630	40	-	0.250	38	38	33	75

PF 2 01 950 010



Elbow 45° PVC-U metric

• (*) Traded items

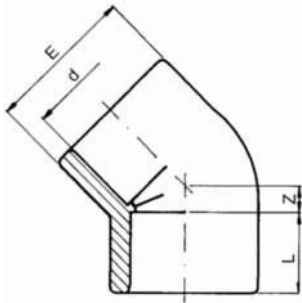

d [mm]	PN	d [inch]	Code	SP	GP	kg	L [mm]	Z [mm]	E [mm]
16	16		RV0GY1160	100	400	0.010	14.0	5.0	23
20	16		RV0GY1200	100	300	0.017	16.0	5.0	28
25	16		RV0GY1250	100	200	0.029	19.0	6.0	34
32	16		RV0GY1320	10	100	0.047	22.0	8.0	42
40	16		RV0GY1400	80	-	0.076	26.0	10.0	51
50	16		RV0GY1500	100	-	0.110	31.0	12.0	61
63	16		RV0GY1630	50	-	0.180	38.0	14.0	75
75	16	2 ½	RV0GY1750	65	-	0.310	44.0	17.0	89
90	16		RV0GY1900	40	-	0.486	51.0	20.0	106
110	16		RV0GY1910	22	-	0.836	61.0	24.0	129
125	16		RV0GY1920	14	-	1.095	69.0	27.0	145
140	16	5	RV0GY1930	8	-	1.600	76.0	31.0	163
160	16		RV0GY1940	6	-	2.240	86.0	35.0	185
200	16		RV0GY1960	30	-	3.780	106.0	43.0	228
225	10		RV0GY1970	24	-	5.755	119.0	49.0	255
* 250	10		RV0GY1980	1	-	7.680	131.0	58.0	287
* 315	10		RV0GY1991	1	-	14.700	164.0	66.0	360

PF 2 01 950 010

Double socket PVC-U metric

• (*) Traded items

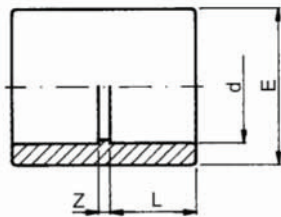

d [mm]	d [inch]	PN	Code	SP	GP	kg	L [mm]	Z [mm]	E [mm]
16		16	RV0MAI160	100	500	0.009	14.0	3	22
20		16	RV0MAI200	100	300	0.010	16.0	3	26
25		16	RV0MAI250	100	200	0.016	19.0	3	32
32		16	RV0MAI320	10	130	0.026	22.0	3	40
40		16	RV0MAI400	100	-	0.043	26.0	3	48
50		16	RV0MAI500	60	-	0.075	31.0	3	60
63		16	RV0MAI630	70	-	0.121	38.0	3	74
75	2 ½	16	RV0MAI750	48	-	0.226	44.0	4	89
90		16	RV0MAI900	50	-	0.361	51.0	5	106
110		16	RV0MAI910	36	-	0.625	61.0	6	129
125		16	RV0MAI920	24	-	0.840	69.0	7	145
140	5	16	RV0MAI930	14	-	1.100	76.0	8	162
160		16	RV0MAI940	9	-	1.400	86.0	8	184
200		16	RV0MAI960	4	-	2.560	106.0	10	227
225		10	RV0MAI970	2	-	3.540	119.0	10	252
* 250		10	RV0MAI980	1	-	5.250	131.0	10	287
* 315		10	RV0MAI991	1	-	10.000	164.0	12	355

PF 2 01 950 010

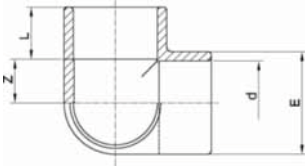

PF 2 01 950 010

Three way elbow PVC-U metric

d [mm]	PN	Code	SP	GP	kg	E [mm]	L [mm]	Z [mm]
50	16	RV0GTI500	50	-	0.155	61	31	26
63	16	RV0GTI630	25	-	0.250	75	38	33

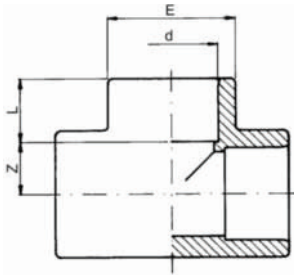

PF 2 01 950 010

Tee 90° PVC-U metric

• (*) Traded items

d [mm]	d [inch]	PN	Code	SP	GP	kg	L [mm]	Z [mm]	E [mm]
16		16	RV0TII160	100	300	0.017	14	9	22
20		16	RV0TII200	100	200	0.029	16	11	26
25		16	RV0TII250	10	100	0.032	19	14	32
32		16	RV0TII320	10	130	0.055	22	17	40
40		16	RV0TII400	45	-	0.127	26	21	51
50		16	RV0TII500	50	-	0.185	31	26	61
63		16	RV0TII630	25	-	0.315	38	33	75
75	2 ½	16	RV0TII750	35	-	0.523	44	39	89
90		16	RV0TII900	20	-	0.830	51	47	106
110		16	RV0TII910	14	-	1.430	61	57	129
125		16	RV0TII920	8	-	1.960	69	66	148
140	5	16	RV0TII930	6	-	2.650	76	72	163
160		16	RV0TII940	4	-	4.350	86	82	190
200		16	RV0TII960	20	-	6.540	106	102	228
225		10	RV0TII970	15	-	8.630	119	115	255
* 250		10	RV0TII980	1	-	12.600	131	128	286
* 315		10	RV0TII991	1	-	23.400	161	162	360

Reduced tee 90° PVC-U metric

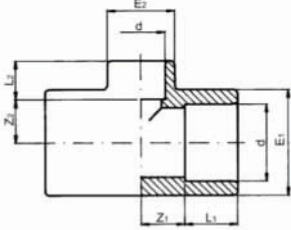

d-d [mm]	PN	Code	SP	GP	kg	L1 [mm]	L2 [mm]	Z1 [mm]	Z2 [mm]	E1 [mm]	E2 [mm]
20 - 16	16	RV0TRI20A	100	200	0.016	16	14	11	11	28.0	23.0
25 - 16	16	RV0TRI25A	10	120	0.041	19	14	14	14	34.0	23.0
25 - 20	16	RV0TRI25B	10	120	0.042	19	16	14	14	34.0	28.0
32 - 16	16	RV0TRI32A	10	140	0.068	22	14	17	17	42.0	23.0
32 - 20	16	RV0TRI32B	10	140	0.066	22	16	17	17	42.0	28.0
32 - 25	16	RV0TRI32C	10	140	0.070	22	19	17	17	42.0	34.0
40 - 20	16	RV0TRI40B	100	-	0.105	26	16	21	21	51.0	28.0
40 - 25	16	RV0TRI40C	100	-	0.111	26	19	21	21	51.0	34.0
40 - 32	16	RV0TRI40D	100	-	0.112	26	22	21	21	51.0	42.0
50 - 20	16	RV0TRI50B	50	-	0.156	31	16	26	26	61.0	28.0
50 - 25	16	RV0TRI50C	50	-	0.162	31	19	26	26	61.0	34.0
50 - 32	16	RV0TRI50D	50	-	0.162	31	22	26	26	61.0	42.0
50 - 40	16	RV0TRI50E	50	-	0.173	31	26	26	26	61.0	51.0
63 - 20	16	RV0TRI63B	30	-	0.268	38	16	33	33	75.0	28.0
63 - 25	16	RV0TRI63C	30	-	0.270	38	19	33	33	75.0	34.0
63 - 32	16	RV0TRI63D	30	-	0.274	38	22	33	33	75.0	42.0
63 - 40	16	RV0TRI63E	30	-	0.277	38	26	33	33	75.0	51.0
63 - 50	16	RV0TRI63F	30	-	0.278	38	31	33	33	75.0	61.0
75 - 32	16	RV0TRI75D	18	-	0.463	44	22	39	39	89.0	42.0
75 - 40	16	RV0TRI75E	45	-	0.460	44	26	39	39	89.0	51.0
75 - 50	16	RV0TRI75F	18	-	0.464	44	31	39	39	89.0	61.0
75 - 63	16	RV0TRI75G	30	-	0.478	44	38	39	39	89.0	75.0
90 - 40	16	RV0TRI90E	30	-	0.702	51	26	47	47	106.0	61.0
90 - 50	16	RV0TRI90F	28	-	0.703	51	31	47	47	106.0	61.0
90 - 63	16	RV0TRI90G	24	-	0.713	51	38	47	47	106.0	75.0
90 - 75	16	RV0TRI90H	24	-	0.731	51	44	47	47	106.0	89.0
110 - 50	16	RV0TRI91F	16	-	1.245	61	31	57	57	129.0	61.0
110 - 63	16	RV0TRI91G	16	-	1.250	61	38	57	57	129.0	75.0
110 - 75	16	RV0TRI91H	16	-	1.255	61	44	57	57	129.0	89.0
110 - 90	16	RV0TRI91I	14	-	1.297	61	51	57	57	129.0	106.0
125 - 63	16	RV0TRI92G	9	-	1.955	69	38	66	66	148.0	75.0
125 - 90	16	RV0TRI92I	9	-	1.740	69	51	66	66	148.0	106.0
125 - 110	16	RV0TRI92L	8	-	2.060	69	61	66	66	148.0	129.0
160 - 90	16	RV0TRI94I	4	-	3.790	86	51	82	82	190.0	106.0
160 - 110	16	RV0TRI94L	4	-	3.840	86	61	82	82	190.0	129.0

PF 2 01 950 010

Manifold tee PVC-U metric

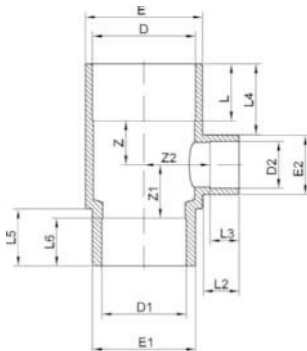

E x D1 x D2 [mm]	PN	Code	SP	GP	kg
90 x 63 x 40	16	RV0TDI900	18	-	0.500
140 x 110 x 50	16	RV0TDI930	6	-	0.995

E x D1 x D2 [mm]	E [mm]	E1 [mm]	E2 [mm]	D [mm]	D1 [mm]	D2 [mm]	Z [mm]	Z1 [mm]	Z2 [mm]	L [mm]	L2 [mm]	L3 [mm]	L4 [mm]
90 x 63 x 40	90	75.0	50.0	75	63	40	39	58	51	44	31	26	46
140 x 110 x 50	140	125.0	63.0	125	110	50	47	47	79	61	38	31	75

E x D1 x D2 [mm]	L5 [mm]	L6 [mm]
90 x 63 x 40	44	38
140 x 110 x 50	61	61

PF 2 01 950 010



Adaptor cross PVC-U metric

E x D2 x D3 [mm]	PN	Code	SP	GP	kg
90 x 63 x 40	16	RV0TCI900	12	-	0.570

E x D2 x D3 [mm]	E	E1	E2	E3	D	D1	D2	D3	Z	Z1	z2	z3	L
90 x 63 x 40	90	75.0	75.0	50.0	75	63	63	40	39	58	51.5	60	44

E x D2 x D3 [mm]	L1	L2	L3	L4	L5	L6
90 x 63 x 40	38	46	31	26	53	38

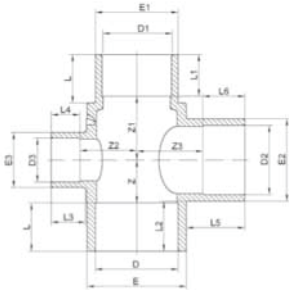

PF 2 01 950 010



Cross 90° PVC-U metric

• (*) Traded items

d [mm]	PN	Code	SP	GP	kg	L [mm]	Z [mm]	D [mm]
* 20	16	RV0CRI200	120	-	0.030	16	11	27.5
* 25	16	RV0CRI250	80	-	0.060	19	14	33.5
* 32	16	RV0CRI320	130	-	0.105	22	17	42.0
* 40	16	RV0CRI400	35	-	0.175	26	21	51.0
* 50	16	RV0CRI500	35	-	0.265	31	26	61.0
* 63	16	RV0CRI630	18	-	0.505	38	33	75.0
* 75	10	RV0CRI750	24	-	0.735	44	40	91.0
* 90	10	RV0CRI900	18	-	1.180	51	46	106.0
* 110	10	RV0CRI910	9	-	1.588	61	56	129.5

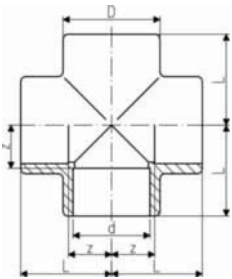

PF 2 01 950 013

Reducing socket PVC-U metric

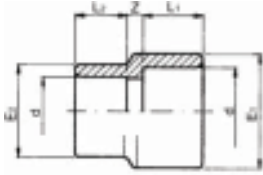

PF 2 01 950 010

d-d [mm]	PN	Code	SP	GP	kg	L1 [mm]	L2 [mm]	Z [mm]	E1 [mm]	E2 [mm]
20 - 16	16	RV0MRI20A	270	-	0.010	16	14	6	28.0	23.0
25 - 20	16	RV0MRI25B	200	-	0.016	19	16	6	34.0	28.0
32 - 25	16	RV0MRI32C	150	-	0.027	22	19	6	42.0	34.0
40 - 32	16	RV0MRI40D	100	-	0.055	26	22	6	51.0	42.0
50 - 40	16	RV0MRI50E	60	-	0.081	31	26	6	61.0	51.0
63 - 50	16	RV0MRI63F	70	-	0.132	38	31	6	75.0	61.0
75 - 63	16	RV0MRI75G	50	-	0.215	44	38	4	89.0	75.0
90 - 75	16	RV0MRI90H	42	-	0.350	51	44	5	106.0	89.0
110 - 90	16	RV0MRI91I	48	-	0.550	61	51	6	129.0	106.0
125 - 110	16	RV0MRI92L	22	-	0.740	69	61	24	145.0	129.0
140 - 110	16	RV0MRI93L	18	-	0.970	76	61	25	160.0	129.0
140 - 125	16	RV0MRI93M	16	-	1.025	76	69	19	160.0	145.0
160 - 110	16	RV0MRI94L	12	-	1.220	86	61	24	181.0	130.0
160 - 140	16	RV0MRI94N	9	-	1.350	86	76	8	184.0	162.0
200 - 160	16	RV0MRI96O	6	-	2.360	106	86	24	227.0	184.0
225 - 200	10	RV0MRI97Q	4	-	3.220	119	106	10	255.0	227.0

Bend 90° PVC-U metric

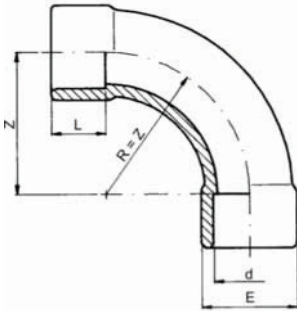

PF 2 01 950 013

• (*) Traded items

d [mm]	d [inch]	PN	Code	SP	GP	kg	L [mm]	Z [mm]	E [mm]
* 20		16	RV0CUI200	160	-	0.045	16	40	29
* 25		16	RV0CUI250	100	-	0.070	19	50	36
* 32		16	RV0CUI320	50	-	0.125	22	64	43
* 40		16	RV0CUI400	60	-	0.210	26	80	54
* 50		16	RV0CUI500	60	-	0.318	31	100	61
* 63		16	RV0CUI630	30	-	0.550	38	126	76
* 75	2 ½	16	RV0CUI750	20	-	1.015	44	150	94
* 90		16	RV0CUI900	12	-	1.787	51	180	113
* 110		16	RV0CUI910	6	-	2.888	61	220	137

Cap PVC-U metric

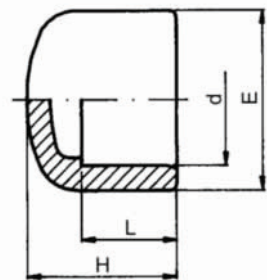

PF 2 01 950 010

d [mm]	d [inch]	PN	Code	SP	GP	kg	L [mm]	H [mm]	E [mm]
16		16	RV0CAI160	100	600	0.005	14.0	22	22
20		16	RV0CAI200	100	500	0.008	16.0	26	26
25		16	RV0CAI250	100	400	0.013	19.0	30	32
32		16	RV0CAI320	100	200	0.022	22.0	33	40
40		16	RV0CAI400	100	-	0.047	26.0	41	51
50		16	RV0CAI500	80	-	0.070	31.0	46	61
63		16	RV0CAI630	50	-	0.118	38.0	55	75
75	2 ½	16	RV0CAI750	25	-	0.187	44.0	64	89
90		16	RV0CAI900	20	-	0.301	51.0	73	106
110		16	RV0CAI910	25	-	0.510	61.0	87	129
125		16	RV0CAI920	36	-	0.665	69.0	98	145
140	5	16	RV0CAI930	30	-	0.915	76.0	108	162
160		16	RV0CAI940	18	-	1.195	86.0	123	182
200		16	RV0CAI960	8	-	2.115	106.0	149	228
225		10	RV0CAI970	6	-	2.835	119.0	165	256

Union with o-ring PVC-U metric

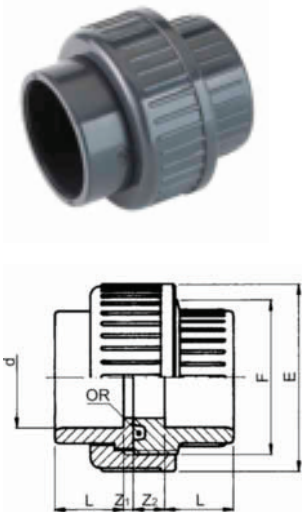

d [mm]	d [inch]	PN	EPDM Code	SP	GP	kg	L [mm]	Z1 [mm]	Z2 [mm]	E [mm]	F [inch]
16		16	RV0BOI160	100	300	0.025	14.0	3	10	34	¾
20		16	RV0BOI200	100	200	0.042	16.0	3	10	42	1
25		16	RV0BOI250	10	100	0.066	19.0	3	10	52	1 ¼
32		16	RV0BOI320	10	60	0.093	22.0	3	10	59	1 ½
40		16	RV0BOI400	100	-	0.160	26.0	3	12	73	2
50		16	RV0BOI500	60	-	0.200	31.0	3	14	82	2 ¼
63		16	RV0BOI630	36	-	0.355	38.0	3	18	100	2 ¾
75	2 ½	16	RV0BOI750	10	-	0.575	44.0	3	18	119	3 ½
90		16	RV0BOI900	15	-	0.765	51.0	5	18	134	4
110		16	RV0BOI910	18	-	1.285	61.0	5	18	163	5

PF 2 01 950 010

Nut PVC-U

Suitable for BOI/BOF/BOP

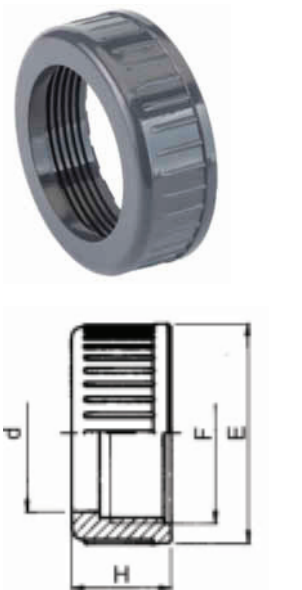

d [mm]	PN	Code	SP	GP	kg	d [mm]	H [mm]	F [inch]	E [mm]
16	16	RV0BGO160	450	-	0.013	22.1	21	¾	34
20	16	RV0BGO200	400	-	0.015	27.6	23	1	42
25	16	RV0BGO250	170	-	0.025	36.1	25	1 ¼	52
32	16	RV0BGO320	180	-	0.035	41.6	27	1 ½	59
40	16	RV0BGO400	100	-	0.060	53.1	30	2	72
50	16	RV0BGO500	125	-	0.080	59.1	34	2 ¼	79
63	16	RV0BGO630	100	-	0.130	74.1	38	2 ¾	96
75	16	RV0BGO750	50	-	0.200	92.6	45	3 ½	119
90	16	RV0BGO900	80	-	0.285	105.1	52	4	134
110	16	RV0BGO910	50	-	0.445	129.2	60	5	163

PF 2 01 950 010

Union bush PVC-U

Suitable for BOI



d [mm]	d [inch]	PN	Code	SP	GP	kg	L [mm]	Z [mm]	F [inch]
16		16	RV0BFI160	600	-	0.009	14.0	10.0	¾
20		16	RV0BFI200	350	-	0.015	16.0	10.0	1
25		16	RV0BFI250	250	-	0.024	19.0	10.0	1 ¼
32		16	RV0BFI320	160	-	0.034	22.0	10.0	1 ½
40		16	RV0BFI400	75	-	0.057	26.0	12.0	2
50		16	RV0BFI500	50	-	0.078	31.0	14.0	2 ¼
63		16	RV0BFI630	60	-	0.134	38.0	18.0	2 ¾
75	2 ½	16	RV0BFI750	125	-	0.205	44.0	18.0	3 ½
90		16	RV0BFI900	80	-	0.270	51.0	18.0	4
110		16	RV0BFI910	48	-	0.465	61.0	18.0	5

PF 2 01 950 010

Reducing bush PVC-U metric

• (*) Traded items

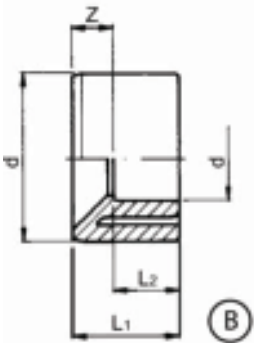
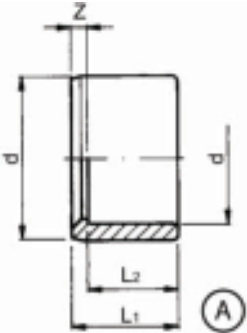

d-d [mm]	PN	Code	SP	GP	kg	L1 [mm]	L2 [mm]	Z [mm]
A 20 - 16	16	RV0RCI20A	100	800	0.003	16	14	2
B 25 - 16	16	RV0RCI25A	100	600	0.008	19	14	5
A 25 - 20	16	RV0RCI25B	100	600	0.005	19	16	3
B 32 - 16	16	RV0RCI32A	100	400	0.015	22	14	8
B 32 - 20	16	RV0RCI32B	100	400	0.015	22	16	6
A 32 - 25	16	RV0RCI32C	100	400	0.010	22	19	3
B 40 - 20	16	RV0RCI40B	100	200	0.025	26	16	10
B 40 - 25	16	RV0RCI40C	100	200	0.027	26	19	7
A 40 - 32	16	RV0RCI40D	100	200	0.016	26	22	4
B 50 - 25	16	RV0RCI50C	180	-	0.045	31	19	12
B 50 - 32	16	RV0RCI50D	180	-	0.042	31	22	9
A 50 - 40	16	RV0RCI50E	180	-	0.030	31	26	5
B 63 - 32	16	RV0RCI63D	100	-	0.083	38	22	16
B 63 - 40	16	RV0RCI63E	100	-	0.081	38	26	12
A 63 - 50	16	RV0RCI63F	100	-	0.062	38	31	7
B 75 - 40	16	RV0RCI75E	60	-	0.120	44	26	18
B 75 - 50	16	RV0RCI75F	60	-	0.122	44	31	13
A 75 - 63	16	RV0RCI75G	60	-	0.082	44	38	6
B 90 - 50	16	RV0RCI90F	30	-	0.210	51	31	20
B 90 - 63	16	RV0RCI90G	30	-	0.195	51	38	13
A 90 - 75	16	RV0RCI90H	30	-	0.140	51	44	7
B 110 - 63	16	RV0RCI91G	20	-	0.365	61	38	23
B 110 - 75	16	RV0RCI91H	20	-	0.365	61	44	17
A 110 - 90	16	RV0RCI91I	20	-	0.273	61	51	10
B 125 - 75	16	RV0RCI92H	30	-	0.412	69	44	25
B 125 - 90	16	RV0RCI92I	30	-	0.450	69	51	18
A 125 - 110	16	RV0RCI92L	30	-	0.273	69	61	8
B 140 - 90	16	RV0RCI93I	22	-	0.550	76	51	25
B 140 - 110	16	RV0RCI93L	22	-	0.475	76	61	15
A 140 - 125	16	RV0RCI93M	22	-	0.340	76	69	7
B 160 - 110	16	RV0RCI94L	13	-	0.795	86	61	25
B 160 - 125	16	RV0RCI94M	13	-	0.725	86	69	17
A 160 - 140	16	RV0RCI94N	13	-	0.545	86	76	10
A 180 - 160	16	RV0RCI95O	20	-	0.710	96	86	10
A 200 - 160	16	RV0RCI96O	15	-	1.645	106	86	10
A 200 - 180	16	RV0RCI96P	15	-	0.870	106	96	10
B 225 - 160	10	RV0RCI97O	9	-	2.300	119	86	33
A 225 - 200	10	RV0RCI97Q	9	-	1.360	119	106	13
*B 250 - 160	10	RV0RCI98O	1	-	3.300	134	87	47
*B 250 - 200	10	RV0RCI98Q	1	-	2.735	134	107	27
*A 250 - 225	10	RV0RCI98R	1	-	1.700	132	120	12
*B 315 - 200	10	RV0RCI991Q	1	-	5.000	165	107	58
*B 315 - 225	10	RV0RCI991R	1	-	4.500	165	132	33
*B 315 - 250	10	RV0RCI991S	1	-	0.001	165	132	33

PF 2 01 950 010

Union end PVC-U

Suitable for BOI/BOP

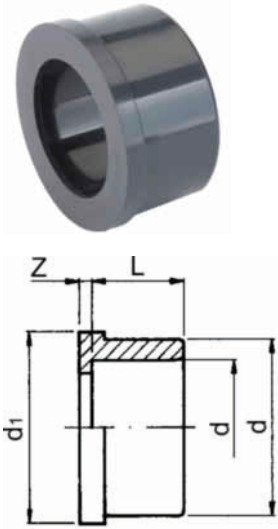

d [mm]	d [inch]	PN	Code	SP	GP	kg	L [mm]	Z [mm]	d [mm]	d1 [mm]
16		16	RV0BLI160	100	1000	0.006	14.0	3.0	22.0	24.0
20		16	RV0BLI200	100	500	0.009	16.0	3.0	27.5	30.1
25		16	RV0BLI250	100	300	0.016	19.0	3.0	36.0	38.8
32		16	RV0BLI320	215	-	0.022	22.0	3.0	41.5	44.7
40		16	RV0BLI400	120	-	0.040	26.0	3.0	53.0	56.5
50		16	RV0BLI500	110	-	0.041	31.0	3.0	59.0	62.6
63		16	RV0BLI630	130	-	0.080	38.0	3.0	74.0	78.4
75	2 ½	16	RV0BLI750	165	-	0.150	44.0	3.0	92.5	97.2
90		16	RV0BLI900	100	-	0.195	51.0	5.0	105.0	110.0
110		16	RV0BLI910	66	-	0.350	61.0	5.0	129.0	135.4

PF 2 01 950 010

Flange adaptor serrated PVC-U metric

- DN indicates the nominal diameter of the PVC pipe
- (*) Traded items

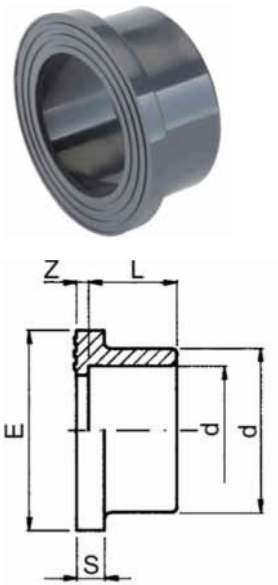

d [mm]	d [inch]	DN [mm]	PN	Code	SP	GP	kg	L [mm]	Z [mm]	d [mm]	S [mm]	E [mm]
20		15	16	RV0QRI200	10	360	0.010	16.0	3.0	27	6	34
25		20	16	RV0QRI250	10	300	0.017	19.0	3.0	33	7	41
32		25	16	RV0QRI320	10	200	0.026	22.0	3.0	41	7	50
40		32	16	RV0QRI400	140	-	0.040	26.0	3.0	50	8	61
50		40	16	RV0QRI500	140	-	0.060	31.0	3.0	61	8	73
63		50	16	RV0QRI630	90	-	0.105	38.0	3.0	76	9	90
75	2 ½	65	16	RV0QRI750	50	-	0.170	44.0	3.0	90	10	106
90		80	16	RV0QRI900	38	-	0.279	51.0	5.0	108	11	125
110		100	16	RV0QRI910	24	-	0.444	61.0	5.0	131	12	150
125		110	16	RV0QRI920	25	-	0.560	69.0	5.0	147	13	168
140	5	125	16	RV0QRI930	20	-	0.750	76.0	5.0	165	14	188
160		150	16	RV0QRI940	15	-	1.030	86.0	5.0	188	16	213
200		200	16	RV0QRI960	8	-	2.000	106.0	7.0	232	18	254
225		200	10	RV0QRI970	6	-	1.775	119.0	7.0	248	19	274
* 250		250	10	RV0QRI980	1	-	2.325	131.0	10.0	273	20	307
* 315		300	10	RV0QRI991	1	-	4.834	164.0	11.0	346	27	379

PF 2 01 950 010

Flat gasket

Suitable for flange adaptor RV0QRI

- (*) Traded items



d [mm]	EPDM Code	SP	GP
* 16	2GRNPD160	-	-
* 20	2GRNPD200	-	-
* 25	2GRNPD250	-	-
* 32	2GRNPD320	-	-
* 40	2GRNPD400	-	-
* 50	2GRNPD500	-	-
* 63	2GRNPD630	-	-
* 75	2GRNPD750	-	-
* 90	2GRNPD900	-	-
* 110	2GRNPD910	-	-
* 125	2GRNPD920	-	-
* 140	2GRNPD930	-	-
* 160	2GRNPD940	-	-
* 200	2GRNPD960	-	-
* 225	2GRNPD970	-	-

Backing flange PVC-U metric

Bolt holes PN10

- DN indicates the nominal diameter of the PVC pipe
- (**) Special flange with bolt holes for DN 140
- (*) Traded items

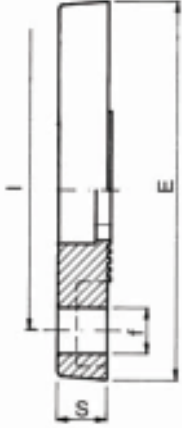

d [mm]	DN [mm]	PN	Code	SP	GP	kg	d [mm]	E [mm]	S [mm]	I [mm]	f [mm]
20	15	16	RV0FLI200	120	-	0.067	28	95	11	65	11
25	20	16	RV0FLI250	100	-	0.090	34	105	12	75	12
32	25	16	RV0FLI320	50	-	0.116	42	115	14	85	14
40	32	16	RV0FLI400	35	-	0.185	51	140	15	100	15
50	40	16	RV0FLI500	70	-	0.215	62	150	16	110	16
63	50	16	RV0FLI630	45	-	0.300	78	165	18	125	18
75	65	16	RV0FLI750	50	-	0.355	92	185	19	145	19
90	80	16	RV0FLI900	38	-	0.435	110	200	20	160	20
110	100	16	RV0FLI910	24	-	0.520	133	220	22	180	22
125	110	16	RV0FLI920	25	-	0.570	149	230	24	190	24
** 125	125	16	RV0FAI920	20	-	0.819	149	250	26	210	26
140	125	16	RV0FLI930	20	-	0.700	167	250	26	210	26
160	150	16	RV0FLI940	15	-	0.975	190	285	28	240	28
200	200	16	RV0FLI960	8	-	1.230	235	340	30	295	30
225	200	16	RV0FLI970	6	-	1.315	250	340	30	295	30
* 250	250	16	RV0FLI980	1	-	1.800	280	395	34	350	22
* 315	300	16	RV0FLI991	1	-	3.180	349	445	31	400	22

PF 2 01 950 010

Fixed flange PVC-U metric

- DN indicates the nominal diameter of the PVC pipe

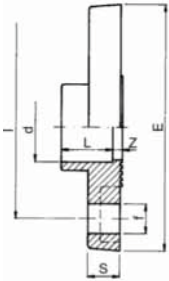

d [mm]	d [inch]	DN [mm]	PN	Code	SP	GP	kg	L [mm]	Z [mm]	E [mm]	S [mm]	I [mm]	f [mm]
20		15	16	RV0FFI200	100	-	0.070	16.0	4.5	95	11	65	14
25		20	16	RV0FFI250	70	-	0.105	19.0	4.5	105	12	75	14
32		25	16	RV0FFI320	120	-	0.145	22.0	4.5	115	14	85	14
40		32	16	RV0FFI400	60	-	0.220	26.0	4.5	140	15	100	18
50		40	16	RV0FFI500	50	-	0.270	31.0	4.5	150	16	110	18
63		50	16	RV0FFI630	40	-	0.380	38.0	4.5	165	18	125	18
75	2 ½	65	16	RV0FFI750	20	-	0.505	44.0	6.0	185	19	145	18
90		80	16	RV0FFI900	15	-	0.685	51.0	7.0	200	20	160	18
110		100	16	RV0FFI910	10	-	0.940	61.0	8.0	220	22	180	18
125		110	16	RV0FFI920	6	-	1.033	69.0	7.0	230	24	190	18
140	5	125	16	RV0FFI930	6	-	1.335	76.0	7.0	250	26	210	18
160		140	16	RV0FFI940	5	-	1.853	86.0	7.0	285	28	240	18

PF 2 01 950 010



Blind flange PVC-U metric

Bolt holes PN10

- DN indicates the nominal diameter of the PVC pipe

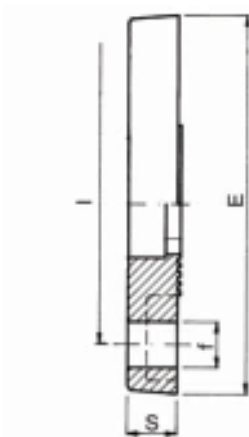

d [mm]	DN [mm]	PN	Code	SP	GP	kg	E [mm]	S [mm]	I [mm]	f [mm]
20	15	16	RV0FCI200	120	-	0.073	95	11	65	14
25	20	16	RV0FCI250	100	-	0.095	105	12	75	14
32	25	16	RV0FCI320	140	-	0.135	115	14	85	14
40	32	16	RV0FCI400	100	-	0.220	140	15	100	18
50	40	16	RV0FCI500	70	-	0.270	150	16	110	18
63	50	16	RV0FCI630	50	-	0.370	165	18	125	18
75	65	16	RV0FCI750	45	-	0.495	185	19	145	18
90	80	16	RV0FCI900	38	-	0.630	200	20	160	18
110	100	16	RV0FCI910	25	-	0.840	220	22	180	18
125	110	16	RV0FCI920	20	-	0.890	230	24	190	18
140	125	16	RV0FCI930	18	-	1.000	250	26	210	18
160	150	16	RV0FCI940	14	-	1.620	285	28	240	22
200	200	16	RV0FCI960	8	-	2.480	340	30	295	22
225	200	16	RV0FCI970	8	-	2.480	340	30	295	22

PF 2 01 950 010



Long size repair socket PVC-U metric

- (*) Traded items



d [mm]	PN	Code	SP	GP	kg	L [mm]	S [mm]
* 63	10	RV0MYI630	16	-	0.905	500	3.0
* 75	10	RV0MYI750	16	-	1.535	500	3.6
* 90	10	RV0MYI900	12	-	2.190	500	4.3
* 110	10	RV0MYI910	8	-	1.642	500	5.3
* 125	10	RV0MYI920	6	-	2.565	500	6.0
* 140	10	RV0MYI930	4	-	3.480	500	6.7
* 160	10	RV0MYI940	4	-	3.240	500	7.7
* 200	10	RV0MYI960	15	-	6.168	600	9.6
* 225	10	RV0MYI970	15	-	6.175	650	10.8

PF 2 01 950 013



Short size repair socket PVC-U metric

- (*) Traded items

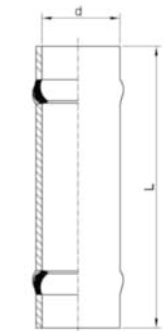

d [mm]	PN	Code	SP	GP	kg	L [mm]	S [mm]
* 63	10	RV0MXI630	36	-	0.680	350	3.0
* 75	10	RV0MXI750	24	-	0.500	350	3.6
* 90	10	RV0MXI900	16	-	0.763	350	4.3
* 110	10	RV0MXI910	12	-	1.100	350	5.3
* 125	10	RV0MXI920	8	-	1.730	350	6.0
* 140	10	RV0MXI930	6	-	2.480	350	6.7
* 160	10	RV0MXI940	6	-	2.300	350	7.7
* 200	10	RV0MXI960	2	-	5.100	400	9.6
* 225	10	RV0MXI970	12	-	6.470	500	10.8

PF 2 01 950 013

Saddle socket M/F PVC-U metric

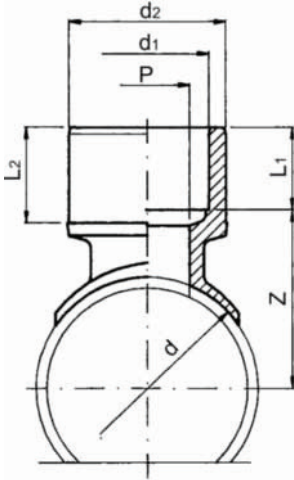

d [mm]	d1 [mm]	d2 [mm]	PN	Code	SP	GP	kg	L1 [mm]	L2 [mm]	Z [mm]	P [mm]
32	20	25	10	DV0DEI32B	500	-	0.012	16	19	32	14
40	20	25	10	DV0DEI40B	500	-	0.012	16	19	38	14
40	25	32	10	DV0DEI40C	300	-	0.021	19	22	38	19
50	20	25	10	DV0DEI50B	500	-	0.012	16	19	43	14
50	25	32	10	DV0DEI50C	300	-	0.021	19	22	43	19
50	32	40	10	DV0DEI50D	170	-	0.035	22	26	45	24
63	20	25	10	DV0DEI63B	500	-	0.013	16	19	49	14
63	25	32	10	DV0DEI63C	300	-	0.021	19	22	50	19
63	32	40	10	DV0DEI63D	170	-	0.035	22	26	51	24
63	40	50	10	DV0DEI63E	110	-	0.058	26	31	55	30
75	20	25	10	DV0DEI75B	500	-	0.013	16	19	55	14
75	25	32	10	DV0DEI75C	300	-	0.021	19	22	56	19
75	32	40	10	DV0DEI75D	350	-	0.034	22	26	57	24
75	40	50	10	DV0DEI75E	200	-	0.058	26	31	61	30
75	50	63	10	DV0DEI75F	110	-	0.101	31	38	63	38
90	20	25	10	DV0DEI90B	500	-	0.013	16	19	63	14
90	25	32	10	DV0DEI90C	300	-	0.023	19	22	63	19
90	32	40	10	DV0DEI90D	400	-	0.036	22	26	65	24
90	40	50	10	DV0DEI90E	200	-	0.058	26	31	68	30
90	50	63	10	DV0DEI90F	110	-	0.108	31	38	71	38
90	63	75	10	DV0DEI90G	70	-	0.142	38	44	70	48
110	20	25	10	DV0DEI91B	500	-	0.013	16	16	73	14
110	25	32	10	DV0DEI91C	300	-	0.023	19	22	73	19
110	32	40	10	DV0DEI91D	400	-	0.034	22	26	75	24
110	40	50	10	DV0DEI91E	200	-	0.058	26	31	78	30
110	50	63	10	DV0DEI91F	110	-	0.108	31	38	81	38
110	63	75	10	DV0DEI91G	70	-	0.137	38	44	80	48
125	25	32	10	DV0DEI92C	300	-	0.023	19	22	81	19
125	32	40	10	DV0DEI92D	400	-	0.036	22	26	82	24
125	40	50	10	DV0DEI92E	200	-	0.058	26	31	86	30
125	50	63	10	DV0DEI92F	110	-	0.108	31	38	88	38
125	63	75	10	DV0DEI92G	70	-	0.137	38	44	88	48
140	32	40	10	DV0DEI93D	400	-	0.036	22	26	90	24
140	40	50	10	DV0DEI93E	200	-	0.059	26	31	93	30
140	50	63	10	DV0DEI93F	110	-	0.108	31	38	96	38
140	63	75	10	DV0DEI93G	70	-	0.140	38	44	95	48
160	25	32	10	DV0DEI94C	300	-	0.023	19	22	98	19
160	32	40	10	DV0DEI94D	400	-	0.036	22	26	100	24
160	40	50	10	DV0DEI94E	200	-	0.062	26	31	103	30
160	50	63	10	DV0DEI94F	110	-	0.108	31	38	106	38
160	63	75	10	DV0DEI94G	70	-	0.137	38	44	105	48
200	32	40	10	DV0DEI96D	400	-	0.036	22	26	120	24
200	40	50	10	DV0DEI96E	200	-	0.062	26	31	123	30
200	50	63	10	DV0DEI96F	110	-	0.108	31	38	126	38
200	63	75	10	DV0DEI96G	70	-	0.137	38	44	125	48
225	50	63	10	DV0DEI97F	110	-	0.108	31	38	138	38
225	63	75	10	DV0DEI97G	70	-	0.137	38	44	138	48
250	50	63	10	DV0DEI98F	110	-	0.108	31	38	151	38
250	63	75	10	DV0DEI98G	70	-	0.137	38	44	150	48
315	50	63	10	DV0DEI99F	110	-	0.108	31	38	183	38
315	63	75	10	DV0DEI99G	70	-	0.137	38	44	183	48

PF 2 01 950 011

Solvent cement hose adaptor PVC-U

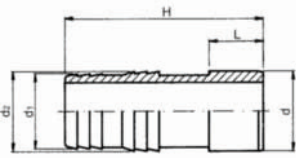

PF 2 01 950 010

d-d-d [mm]	PN	Code	SP	GP	kg	L [mm]	H [mm]	d1 [mm]	d2 [mm]
16 - 18 - 16	16	RV0PGI160	100	400	0.007	14.0	60	16	18
20 - 22 - 20	16	RV0PGI200	100	300	0.013	16.0	67	20	22
25 - 27 - 25	16	RV0PGI250	100	200	0.021	19.0	74	25	27
32 - 32 - 30	16	RV0PGI320	10	130	0.032	22.0	80	30	32
40 - 42 - 40	16	RV0PGI400	100	-	0.055	26.0	92	40	42
50 - 52 - 50	16	RV0PGI500	100	-	0.081	31.0	101	50	52
63 - 64 - 60	16	RV0PGI630	60	-	0.142	38.0	111	60	64

PVC-U fittings B.S.P. threaded range

Saddle with female thread Rp PVC-U

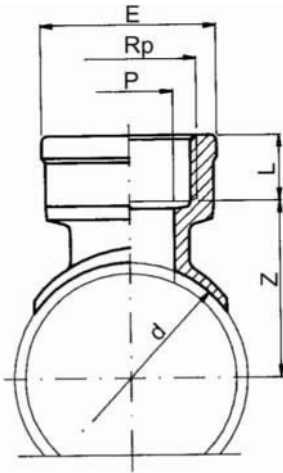

d [mm]	Rp [inch]	PN	Code	SP	GP	kg	L [mm]	Z [mm]	P [mm]	E [mm]
32	¼	10	DV0DEF32Z	500	-	0.010	12.9	28.9	11	24.2
32	¾	10	DV0DEF32A	500	-	0.015	14.0	28.0	11	24.2
32	½	10	DV0DEF32B	500	-	0.015	15.0	33.0	14	30.0
40	¼	10	DV0DEF40Z	500	-	0.010	12.9	32.9	11	24.2
40	¾	10	DV0DEF40A	500	-	0.009	14.0	32.0	11	24.2
40	½	10	DV0DEF40B	500	-	0.015	15.0	37.0	14	30.0
40	¾	10	DV0DEF40C	270	-	0.021	16.3	38.0	19	36.0
50	¼	10	DV0DEF50Z	500	-	0.010	12.9	37.9	11	24.2
50	¾	10	DV0DEF50A	500	-	0.015	14.0	37.0	11	24.2
50	½	10	DV0DEF50B	500	-	0.015	15.0	42.0	14	30.0
50	¾	10	DV0DEF50C	270	-	0.024	16.3	43.0	19	36.0
50	1	10	DV0DEF50D	170	-	0.036	19.1	44.0	24	45.0
63	¼	10	DV0DEF63Z	500	-	0.010	12.9	44.4	11	24.2
63	¾	10	DV0DEF63A	500	-	0.015	14.0	43.5	11	24.2
63	½	10	DV0DEF63B	500	-	0.015	15.0	48.0	14	30.0
63	¾	10	DV0DEF63C	270	-	0.023	16.3	49.0	19	36.0
63	1	10	DV0DEF63D	170	-	0.039	19.1	50.0	24	45.0
63	1 ¼	10	DV0DEF63E	110	-	0.060	21.4	52.0	30	53.0
75	¼	10	DV0DEF75Z	500	-	0.010	12.9	50.4	11	24.2
75	¾	10	DV0DEF75A	500	-	0.016	14.0	49.5	11	24.2
75	½	10	DV0DEF75B	500	-	0.016	15.0	58.0	38	64.0
75	¾	10	DV0DEF75C	270	-	0.023	16.3	55.0	19	36.0
75	1	10	DV0DEF75D	170	-	0.036	19.1	56.0	24	45.0
75	1 ¼	10	DV0DEF75E	65	-	0.060	21.4	58.0	30	53.0
75	1 ½	10	DV0DEF75F	120	-	0.095	21.4	58.0	38	64.0
90	¼	10	DV0DEF90Z	500	-	0.010	12.9	57.9	11	24.2
90	¾	10	DV0DEF90A	500	-	0.013	14.0	57.0	11	24.2
90	½	10	DV0DEF90B	500	-	0.013	15.0	62.0	14	30.0
90	¾	10	DV0DEF90C	270	-	0.023	16.3	63.0	19	36.0
90	1	10	DV0DEF90D	170	-	0.037	19.1	64.0	24	45.0
90	1 ¼	10	DV0DEF90E	110	-	0.060	21.4	66.0	30	53.0
90	1 ½	10	DV0DEF90F	120	-	0.095	21.4	66.0	38	64.0
90	2	10	DV0DEF90G	90	-	0.105	25.7	67.0	48	78.0
110	½	10	DV0DEF91B	500	-	0.010	15.0	72.0	14	30.0
110	¾	10	DV0DEF91C	270	-	0.023	16.3	73.0	19	36.0
110	1	10	DV0DEF91D	170	-	0.037	19.1	74.0	24	45.0
110	1 ¼	10	DV0DEF91E	110	-	0.060	21.4	76.0	30	53.0
110	1 ½	10	DV0DEF91F	120	-	0.095	21.4	76.0	38	64.0
110	2	10	DV0DEF91G	90	-	0.105	25.7	77.0	48	78.0
125	½	10	DV0DEF92B	500	-	0.016	15.0	79.0	14	30.0
125	¾	10	DV0DEF92C	270	-	0.025	16.3	80.0	19	36.0
125	1	10	DV0DEF92D	170	-	0.036	19.1	81.0	24	45.0
125	1 ¼	10	DV0DEF92E	110	-	0.060	21.4	83.0	30	53.0
125	1 ½	10	DV0DEF92F	120	-	0.095	21.4	83.0	38	64.0
125	2	10	DV0DEF92G	90	-	0.105	25.7	84.0	48	78.0
140	½	10	DV0DEF93B	500	-	0.016	15.0	87.0	14	30.0
140	¾	10	DV0DEF93C	270	-	0.023	16.3	88.0	19	36.0
140	1	10	DV0DEF93D	170	-	0.036	19.1	89.0	24	45.0
140	1 ¼	10	DV0DEF93E	60	-	0.060	21.4	91.0	30	53.0
140	1 ½	10	DV0DEF93F	120	-	0.095	21.4	91.0	38	64.0
140	2	10	DV0DEF93G	90	-	0.105	25.7	92.0	48	78.0
160	¾	10	DV0DEF94C	270	-	0.024	16.3	98.0	19	36.0
160	1	10	DV0DEF94D	170	-	0.036	19.1	99.0	24	45.0
160	1 ¼	10	DV0DEF94E	110	-	0.060	21.4	101.0	30	53.0
160	1 ½	10	DV0DEF94F	120	-	0.095	21.4	101.0	38	64.0
160	2	10	DV0DEF94G	90	-	0.105	25.7	102.0	48	78.0
200	1	10	DV0DEF96D	170	-	0.036	19.1	118.0	2	45.0
200	1 ¼	10	DV0DEF96E	60	-	0.060	21.4	121.0	30	53.0
200	1 ½	10	DV0DEF96F	120	-	0.095	21.4	121.0	38	64.0
200	2	10	DV0DEF96G	90	-	0.125	25.7	122.0	48	78.0
225	1 ¼	10	DV0DEF97E	110	-	0.036	21.4	133.0	30	53.0
225	1 ½	10	DV0DEF97F	120	-	0.060	21.4	133.0	38	64.0

table continued next page



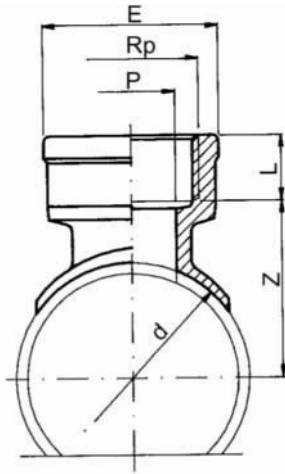

d [mm]	Rp [inch]	PN	Code	SP	GP	kg	L [mm]	Z [mm]	P [mm]	E [mm]
225	2	10	DV0DEF97G	90	-	0.095	25.7	134.0	48	78.0
250	1 1/4	10	DV0DEF98E	110	-	0.105	21.4	146.0	30	53.0
250	1 1/2	10	DV0DEF98F	120	-	0.095	21.4	146.0	38	64.0
250	2	10	DV0DEF98G	90	-	0.105	25.7	147.0	48	78.0
315	1 1/2	10	DV0DEF99F	120	-	0.095	21.4	149.0	38	64.0
315	2	10	DV0DEF99G	90	-	0.105	25.7	180.0	48	78.0

PF 2 01 950 011

Saddle with male thread R PVC-U

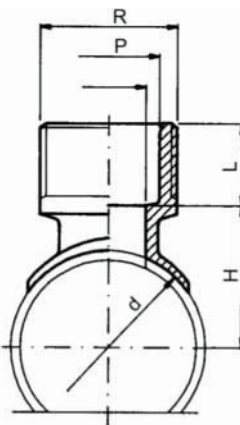

d [mm]	R [inch]	PN	Code	SP	GP	kg	L [mm]	H [mm]	P [mm]
32	1/2	10	DV0DMF32B	500	-	0.010	15.0	33	14
40	1/2	10	DV0DMF40B	350	-	0.012	15.0	37	14
50	1/2	10	DV0DMF50B	350	-	0.012	15.0	42	14
50	1	10	DV0DMF50D	170	-	0.035	19.1	44	24
63	1/2	10	DV0DMF63B	500	-	0.013	15.0	48	14
63	1	10	DV0DMF63D	170	-	0.037	19.1	50	24
75	1/2	10	DV0DMF75B	500	-	0.013	15.0	54	14
75	1	10	DV0DMF75D	400	-	0.036	19.1	56	24
75	1 1/2	10	DV0DMF75F	110	-	0.103	21.4	58	38
90	1/2	10	DV0DMF90B	500	-	0.013	15.0	62	14
90	1	10	DV0DMF90D	400	-	0.036	19.1	64	24
90	1 1/2	10	DV0DMF90F	110	-	0.065	21.4	66	38
90	2	10	DV0DMF90G	110	-	0.120	25.7	67	48
110	1/2	10	DV0DMF91B	500	-	0.013	15.0	72	14
110	1	10	DV0DMF91D	400	-	0.036	19.1	74	24
110	1 1/2	10	DV0DMF91F	110	-	0.063	21.4	76	38
110	2	10	DV0DMF91G	110	-	0.120	25.7	77	48
125	1 1/2	10	DV0DMF92F	110	-	0.108	21.4	83	38
125	2	10	DV0DMF92G	110	-	0.120	25.7	84	48
140	1 1/2	10	DV0DMF93F	110	-	0.060	21.4	91	38
140	2	10	DV0DMF93G	110	-	0.120	25.7	92	48

PF 2 01 950 011

Threaded tee 90° Rp PVC-U

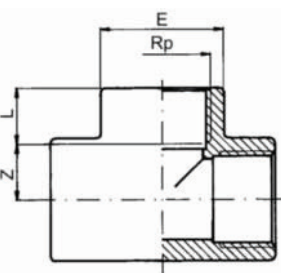

Rp [inch]	PN	Code	SP	GP	kg	L [mm]	Z [mm]	E [mm]
3/8	16	RV0TIF160	10	280	0.018	11.4	11.6	23
1/2	16	RV0TIF200	10	150	0.029	15.0	12.0	28
3/4	16	RV0TIF250	10	100	0.050	16.3	16.7	34
1	16	RV0TIF320	10	130	0.076	19.1	19.9	42
1 1/4	16	RV0TIF400	90	-	0.125	21.4	25.6	51
1 1/2	16	RV0TIF500	50	-	0.240	21.4	35.6	61
2	16	RV0TIF630	25	-	0.435	25.7	45.3	75
1 1/2	16	RV0TIF750	35	-	0.575	30.2	52.8	89
3	16	RV0TIF900	24	-	0.965	33.3	64.7	106
4	16	RV0TIF910	14	-	1.310	39.3	75.7	129

PF 2 01 951 010

Threaded elbow 45° Rp PVC-U

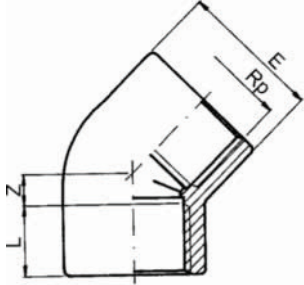

PF 2 01 951 010

Rp [inch]	PN	Code	SP	GP	kg	L [mm]	Z [mm]	E [mm]
3/8	16	RV0GYF160	10	400	0.010	11.4	11.6	23
1/2	16	RV0GYF200	10	260	0.018	15.0	12.0	28
3/4	16	RV0GYF250	10	150	0.031	16.3	16.7	34
1	16	RV0GYF320	10	100	0.051	19.1	19.9	42
1 1/4	16	RV0GYF400	80	-	0.075	21.4	25.6	51
1 1/2	16	RV0GYF500	100	-	0.155	21.4	35.6	61
2	16	RV0GYF630	50	-	0.275	25.7	45.3	75
1 1/2	16	RV0GYF750	65	-	0.360	30.2	52.8	89
3	16	RV0GYF900	40	-	0.620	33.3	64.7	106
4	16	RV0GYF910	22	-	0.830	39.3	78.7	129

Threaded elbow 90° Rp PVC-U

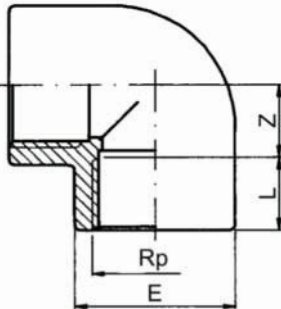

PF 2 01 951 010

Rp [inch]	PN	Code	SP	GP	kg	L [mm]	Z [mm]	E [mm]
3/8	16	RV0GOF160	10	360	0.015	11.4	44.6	23
1/2	16	RV0GOF200	10	200	0.022	15.0	12.0	28
3/4	16	RV0GOF250	10	160	0.037	16.3	16.7	34
1	16	RV0GOF320	10	80	0.059	19.1	19.9	42
1 1/4	16	RV0GOF400	130	-	0.094	21.4	25.6	51
1 1/2	16	RV0GOF500	80	-	0.184	21.4	35.6	61
2	16	RV0GOF630	40	-	0.320	25.7	45.3	75
2 1/2	16	RV0GOF750	50	-	0.425	30.2	52.8	89
3	16	RV0GOF900	30	-	0.770	33.3	64.7	106
4	16	RV0GOF910	17	-	1.050	39.3	78.7	129

Threaded double socket Rp PVC-U

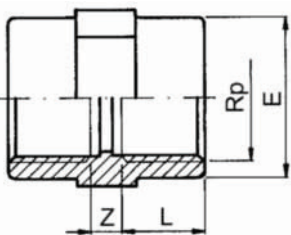

PF 2 01 951 010

Rp [inch]	PN	Code	SP	GP	kg	L [mm]	Z [mm]	E [mm]
3/8	16	RV0MAF160	10	500	0.008	11.4	6	23
1/2	16	RV0MAF200	10	250	0.017	15.0	7	28
3/4	16	RV0MAF250	10	180	0.024	16.3	7	34
1	16	RV0MAF320	10	130	0.042	19.1	8	42
1 1/4	16	RV0MAF400	220	-	0.060	21.4	8	51
1 1/2	16	RV0MAF500	180	-	0.073	21.4	8	58
2	16	RV0MAF630	100	-	0.123	25.7	8	72
2 1/2	16	RV0MAF750	120	-	0.200	30.2	9	89
3	16	RV0MAF900	84	-	0.280	33.3	10	103
4	16	RV0MAF910	44	-	0.441	39.3	11	130
6	16	RV0MAF940	9	-	1.400	48.0	84	182

Threaded reducer R/Rp PVC-U

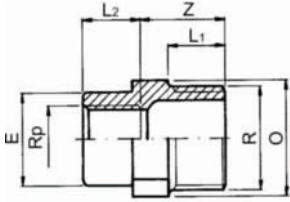

R [inch]	Rp [inch]	PN	Code	SP	GP	kg	L1 [mm]	L2' [mm]	Z [mm]	E [mm]	O [mm]
1/2	3/8	16	RV0RIF20A	10	400	0.012	15.0	11.4	24	32	24
3/4	3/8	16	RV0RIF25A	10	280	0.016	16.3	11.4	25	23	30
3/4	1/2	16	RV0RIF25B	10	280	0.018	16.3	15.0	26	28	30
1	3/8	16	RV0RIF32A	10	160	0.024	19.1	11.4	28	23	36
1	1/2	16	RV0RIF32B	10	160	0.026	19.1	15.0	29	28	36
1	3/4	16	RV0RIF32C	10	160	0.026	19.1	16.3	30	34	36
1 1/4	1/2	16	RV0RIF40B	150	-	0.042	21.4	15.0	33	28	46
1 1/4	3/4	16	RV0RIF40C	150	-	0.045	21.4	16.3	33	34	46
1 1/4	1	16	RV0RIF40D	150	-	0.047	21.4	19.1	33	42	46
1 1/2	3/4	16	RV0RIF50C	120	-	0.050	21.4	16.3	34	34	50
1 1/2	1	16	RV0RIF50D	100	-	0.050	21.4	19.1	34	42	50
1 1/2	1 1/4	16	RV0RIF50E	100	-	0.060	21.4	21.4	34	51	55
2	1	16	RV0RIF63D	140	-	0.086	25.7	19.1	37	42	65
2	1 1/4	16	RV0RIF63E	140	-	0.085	25.7	21.4	37	51	65
2	1 1/2	16	RV0RIF63F	130	-	0.087	25.7	21.4	37	58	65
2 1/2	1 1/4	16	RV0RIF75E	170	-	0.140	30.2	21.4	43	51	80
2 1/2	1 1/2	16	RV0RIF75F	170	-	0.138	30.2	21.4	43	58	80
2 1/2	2	16	RV0RIF75G	150	-	0.142	30.2	25.7	43	72	80
3	1 1/2	16	RV0RIF90F	150	-	0.200	33.3	21.4	47	58	95
3	2	16	RV0RIF90G	125	-	0.205	33.3	25.7	47	72	95
3	2 1/2	16	RV0RIF90H	115	-	0.215	33.3	30.2	47	89	95
4	2	16	RV0RIF91G	85	-	0.330	39.3	25.7	53	72	120
4	2 1/2	16	RV0RIF91H	42	-	0.330	39.3	30.2	53	89	120
4	3	16	RV0RIF91I	60	-	0.350	39.3	33.3	53	103	120

PF 2 01 951 010

Threaded nut Rp PVC-U

• (*) Traded items

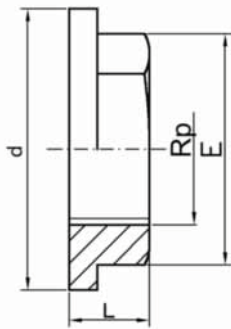

Rp [inch]	PN	Code	SP	GP	kg	D [mm]	L [mm]	E [mm]
* 1/2	16	RV0DAF200	1	800	0.009	38	13	29
* 3/4	16	RV0DAF250	1	1250	0.011	43	14	34
* 1	16	RV0DAF320	1	600	0.026	56	16	46
* 1 1/4	16	RV0DAF400	1	450	0.029	65	18	50
* 1 1/2	16	RV0DAF500	300	-	0.043	72	19	60
* 2	16	RV0DAF630	150	-	0.089	94	21	80
* 2 1/2	16	RV0DAF750	120	-	0.094	115	24	94
* 3	16	RV0DAF900	80	-	0.138	130	27	108
* 4	16	RV0DAF910	45	-	0.205	162	30	135

PF 2 01 950 013

Threaded reducing socket Rp PVC-U

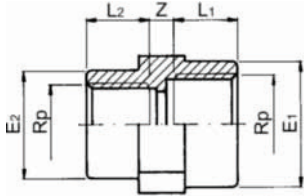

PF 2 01 951 010

Rp [inch]	Rp [inch]	PN	Code	SP	GP	kg	L1 [mm]	L2 [mm]	Z [mm]	E1 [mm]	E2 [mm]
½	¾	16	RV0MRF20A	10	250	0.017	15.0	11.4	6	28.0	23.0
¾	1	16	RV0MRF25B	10	200	0.024	16.3	15.0	7	34.0	28.0
1	1 ¼	16	RV0MRF32C	10	120	0.040	19.1	16.3	7	42.0	34.0
1 ¼	1 ½	16	RV0MRF40D	190	-	0.060	21.4	19.1	8	51.0	42.0
1 ½	2	16	RV0MRF50E	165	-	0.072	21.4	21.4	8	58.0	51.0
2	2 ½	16	RV0MRF63F	80	-	0.115	25.7	21.4	8	72.0	58.0
2 ½	3	16	RV0MRF75G	130	-	0.128	30.2	25.7	8	89.0	72.0
3	3 ½	16	RV0MRF90H	80	-	0.286	33.3	30.2	9	103.0	89.0
4	4 ½	16	RV0MRF91I	54	-	0.436	39.3	33.3	10	130.0	103.0

Threaded reducing bush R/Rp PVC-U

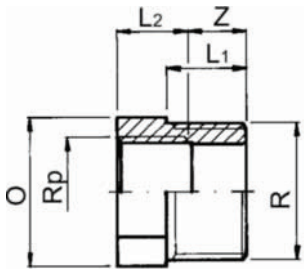

PF 2 01 951 010

R [inch]	Rp [inch]	PN	Code	SP	GP	kg	L1' [mm]	L2' [mm]	Z [mm]	O [mm]
¾	1	16	RV0RCF25B	100	300	0.013	16.3	15.0	13.3	30
1	1 ¼	16	RV0RCF32C	100	250	0.019	19.1	16.3	14.8	36
1 ¼	1 ½	16	RV0RCF40D	200	-	0.033	21.4	19.1	16.3	46
1 ½	2	16	RV0RCF50E	160	-	0.028	21.4	21.4	14.0	50
2	2 ½	16	RV0RCF63F	200	-	0.067	25.7	21.4	18.3	65
2 ½	3	16	RV0RCF75G	200	-	0.135	30.2	25.7	20.5	80
3	3 ½	16	RV0RCF90H	165	-	0.160	33.3	30.2	20.1	95
4	4 ½	16	RV0RCF91I	90	-	0.290	39.3	33.3	24.0	120

Threaded nipple R PVC-U

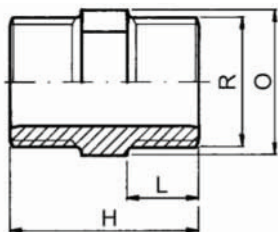

PF 2 01 951 010

R [inch]	PN	Code	SP	GP	kg	L [mm]	H [mm]	O [mm]
¾	16	RV0NIF160	10	600	0.007	11.4	33	22
½	16	RV0NIF200	10	400	0.011	15.0	42	24
¾	16	RV0NIF250	10	280	0.018	16.3	44	30
1	16	RV0NIF320	10	160	0.028	19.1	50	36
1 ¼	16	RV0NIF400	130	-	0.049	21.4	58	46
1 ½	16	RV0NIF500	90	-	0.051	21.4	58	50
2	16	RV0NIF630	125	-	0.095	25.7	66	65
2 ½	16	RV0NIF750	140	-	0.142	30.2	76	80
3	16	RV0NIF900	90	-	0.221	33.3	85	95
4	16	RV0NIF910	45	-	0.345	39.3	96	120

Threaded reducing nipple R PVC-U

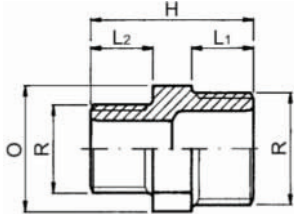

PF 2 01 951 010

R [inch]	R [inch]	PN	Code	SP	GP	kg	L1 [mm]	L2' [mm]	H [mm]	O [mm]
½	¾	16	RV0NRF20A	10	400	0.011	15.0	11.4	38	24
¾	1	16	RV0NRF25B	10	280	0.017	16.3	15.0	43	30
1	¾	16	RV0NRF32C	10	180	0.026	19.1	16.3	47	36
1 ¼	1	16	RV0NRF40D	150	-	0.043	21.4	19.1	56	46
1 ½	1 ¼	16	RV0NRF50E	100	-	0.048	21.4	21.4	58	50
2	1 ½	16	RV0NRF63F	130	-	0.081	25.7	21.4	62	65
2 ½	2	16	RV0NRF75G	110	-	0.140	30.2	25.7	73	80
3	2 ½	16	RV0NRF90H	50	-	0.208	33.3	30.2	82	95
4	3	16	RV0NRF91I	36	-	0.339	39.3	33.3	90	120

Threaded plug R PVC-U

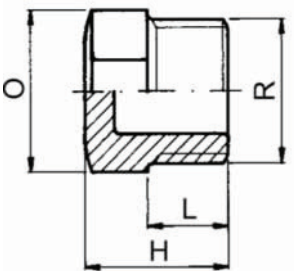

PF 2 01 951 010

R [inch]	PN	Code	SP	GP	kg	L [mm]	H [mm]	O [mm]
¾	16	RV0TAF160	10	700	0.008	11.4	24	22
1	16	RV0TAF200	10	500	0.009	15.0	29	24
1 ¼	16	RV0TAF250	10	320	0.016	16.3	30	30
1 ½	16	RV0TAF320	10	250	0.023	19.1	33	36
2	16	RV0TAF400	200	-	0.041	21.4	39	46
2 ½	16	RV0TAF500	150	-	0.045	21.4	39	50
3	16	RV0TAF630	180	-	0.080	25.7	43	65
3 ½	16	RV0TAF750	100	-	0.140	30.2	51	80
4	16	RV0TAF900	65	-	0.210	33.3	55	95
4 ½	16	RV0TAF910	40	-	0.340	39.3	61	120

Threaded increaser R/Rp PVC-U

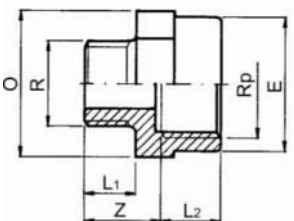

PF 2 01 951 010

R [inch]	Rp [inch]	PN	Code	SP	GP	kg	L1 [mm]	L2 [mm]	Z [mm]	O [mm]
¾	1	16	RV0MGF16B	500	-	0.016	11.4	15.0	22	30
1	1 ¼	16	RV0MGF20C	300	-	0.020	15.0	16.3	24	36
1 ¼	1 ½	16	RV0MGF25D	350	-	0.037	16.3	19.1	26	46
1 ½	2	16	RV0MGF32E	250	-	0.059	19.1	21.4	30	55
2	2 ½	16	RV0MGF40F	180	-	0.074	21.4	21.4	33	60
2 ½	3	16	RV0MGF50G	100	-	0.113	21.4	25.7	34	75
3	3 ½	16	RV0MGF63H	60	-	0.187	25.7	30.2	38	90
3 ½	4	16	RV0MGF75I	54	-	0.262	30.2	33.3	44	105
4	4 ½	16	RV0MGF90L	34	-	0.416	33.3	39.3	48	130

Threaded fixed flange Rp PVC-U

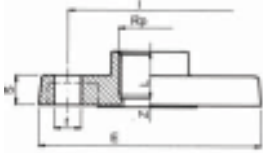

PF 2 01 951 010

Rp [inch]	DN [mm]	PN-PN [bar]	Code	SP	GP	kg	L [mm]	Z [mm]	E [mm]	S [mm]	I [mm]	f [mm]
½	15	10 - 16	RV0FFF200	100	-	0.070	15.0	5.5	95	11	65	14
¾	20	10 - 16	RV0FFF250	70	-	0.105	16.3	7.5	105	12	75	14
1	25	10 - 16	RV0FFF320	120	-	0.148	19.1	7.5	115	14	85	14
1 ¼	32	10 - 16	RV0FFF400	60	-	0.220	21.4	9.0	140	15	100	18
1 ½	40	10 - 16	RV0FFF500	50	-	0.285	21.4	14.0	150	16	110	18
2	50	10 - 16	RV0FFF630	40	-	0.420	25.7	17.0	165	18	125	18
2 ½	65	10 - 16	RV0FFF750	20	-	0.520	30.2	20.0	185	19	145	18
3	80	10 - 16	RV0FFF900	15	-	0.735	30.3	25.0	200	20	160	18
4	100	10 - 16	RV0FFF910	10	-	0.923	39.9	30.0	220	22	180	18

Threaded union Rp with o-ring PVC-U

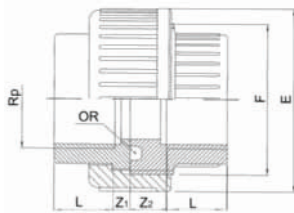

PF 2 01 951 010

Rp [inch]	PN	EPDM Code	SP	GP	kg	L [mm]	Z1 [mm]	Z2 [mm]	F [inch]	E [mm]
¾	16	RV0BOF160	10	250	0.027	11.4	5.6	13.6	¾	34
½	16	RV0BOF200	10	150	0.042	15.0	4.0	11.0	1	42
¾	16	RV0BOF250	10	100	0.068	16.3	5.7	12.7	1 ¼	52
1	16	RV0BOF320	10	60	0.095	19.1	5.9	12.9	1 ½	59
1 ¼	16	RV0BOF400	90	-	0.165	21.4	7.6	16.6	2	72
1 ½	16	RV0BOF500	60	-	0.230	21.4	12.6	23.6	2 ¼	79
2	16	RV0BOF630	36	-	0.410	25.7	15.3	30.3	2 ¾	96
2 ½	16	RV0BOF750	20	-	0.600	30.2	16.8	31.8	3 ½	119
3	16	RV0BOF900	15	-	0.770	33.3	22.7	35.7	4	134
4	16	RV0BOF910	18	-	1.280	39.3	26.7	39.7	5	163

Union bush Rp PVC-U

Suitable for BOF/BOP

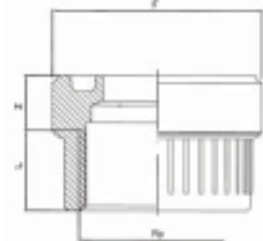

PF 2 01 951 010

Rp [inch]	PN	Code	SP	GP	kg	L [mm]	Z [mm]	F [inch]
¾	16	RV0BFF160	600	-	0.010	11.4	13.6	¾
½	16	RV0BFF200	300	-	0.016	15.0	11.0	1
¾	16	RV0BFF250	180	-	0.027	16.3	12.7	1 ¼
1	16	RV0BFF320	500	-	0.036	19.1	12.9	1 ½
1 ¼	16	RV0BFF400	160	-	0.060	21.4	16.6	2
1 ½	16	RV0BFF500	50	-	0.104	21.4	23.6	2 ¼
2	16	RV0BFF630	60	-	0.168	25.7	30.3	2 ¾
2 ½	16	RV0BFF750	125	-	0.235	30.2	31.8	3 ½
3	16	RV0BFF900	80	-	0.335	33.3	35.7	4
4	16	RV0BFF910	48	-	0.470	39.3	39.7	5

Union end Rp PVC-U

Suitable for BOF

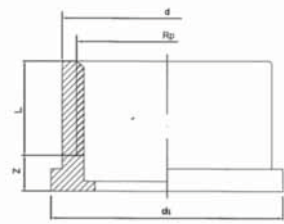

Rp [inch]	PN	Code	SP	GP	kg	L [mm]	Z [mm]	d [mm]	d1 [mm]
3/8	16	RV0BLF160	1000	-	0.007	11.4	5.6	22.0	24.0
1/2	16	RV0BLF200	600	-	0.010	15.0	4.0	27.5	30.1
3/4	16	RV0BLF250	300	-	0.017	16.3	5.7	36.0	38.8
1	16	RV0BLF320	650	-	0.023	19.1	5.9	41.5	44.7
1 1/4	16	RV0BLF400	125	-	0.042	21.4	7.6	53.0	56.5
1 1/2	16	RV0BLF500	85	-	0.065	21.4	12.6	59.0	62.6
2	16	RV0BLF630	45	-	0.120	25.7	15.3	74.0	78.4
2 1/2	16	RV0BLF750	165	-	0.160	30.2	16.8	92.5	97.2
3	16	RV0BLF900	100	-	0.235	33.3	22.7	105.0	110.0
4	16	RV0BLF910	66	-	0.340	39.3	26.7	129.0	135.4

PF 2 01 951 010

Threaded cap Rp PVC-U

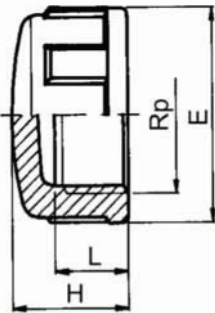

Rp [inch]	PN	Code	SP	GP	kg	L [mm]	H [mm]	E [mm]
3/8	16	RV0CAF160	10	600	0.008	11.4	22.0	23
1/2	16	RV0CAF200	10	500	0.008	15.0	21.0	28
3/4	16	RV0CAF250	10	400	0.013	16.3	23.0	34
1	16	RV0CAF320	10	250	0.022	19.1	26.0	42
1 1/4	16	RV0CAF400	160	-	0.035	21.4	29.0	51
1 1/2	16	RV0CAF500	80	-	0.050	21.4	32.0	61
2	16	RV0CAF630	50	-	0.080	25.7	37.0	75
2 1/2	16	RV0CAF750	90	-	0.190	30.2	50.0	89
3	16	RV0CAF900	60	-	0.270	33.3	53.0	103
4	16	RV0CAF910	34	-	0.435	39.3	59.0	130

PF 2 01 951 010

Threaded hose adaptor R PVC-U

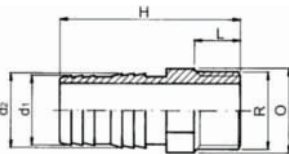

R [inch]	d1 [mm]	d2 [mm]	PN	Code	SP	GP	kg	L [mm]	H [mm]	d1 [mm]	d2 [mm]	O [mm]
3/8	16	18	16	RV0PGF160	10	400	0.009	11.4	56.0	16	18	22
1/2	20	22	16	RV0PGF200	10	280	0.016	15.0	66.0	20	22	24
3/4	25	27	16	RV0PGF250	10	180	0.024	16.3	71.3	25	27	30
1	30	32	16	RV0PGF320	10	130	0.035	19.1	77.1	30	32	36
1 1/4	40	42	16	RV0PGF400	85	-	0.061	21.4	87.4	40	42	46
1 1/2	50	52	16	RV0PGF500	130	-	0.074	21.4	91.4	50	52	50
2	60	64	16	RV0PGF630	70	-	0.126	25.7	98.7	60	64	65

PF 2 01 951 010

Tank connector R PP

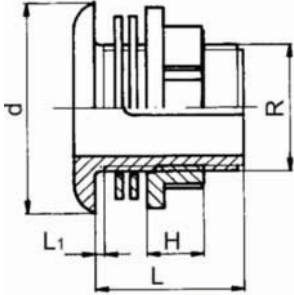

PF 2 01 951 010

R [inch]	PN	Code	SP	GP	kg	D [mm]	L [mm]	L1 [mm]	H [mm]
½	10	RP0ATS200	10	400	0.019	41.0	47	4	18
¾	10	RP0ATS250	10	300	0.028	49.0	47	4	18
1	10	RP0ATS320	10	180	0.038	58.0	49	5	18
1 ¼	10	RP0ATS400	10	120	0.057	70.0	49	5	18
1 ½	10	RP0ATS500	10	150	0.056	79.5	49	9	25

Tape

- (*) Traded items



PF 2 02 962 011

mt [m]	PTFE Code	SP	GP	kg
* 12	Y1TPTF012	10	500	0.012

PVC-U adaptor fittings range

Threaded central offtake tee Rp PVC-U

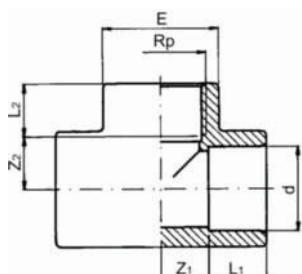

d [mm]	Rp [inch]	d [inch]	PN	Code	SP	GP	kg	L1 [mm]	L2 [mm]	Z1 [mm]	Z2 [mm]	E [mm]
16	3/8		16	RV0TIP16A	10	280	0.017	14	11.4	9	11.6	23
20	1/2		16	RV0TIP20B	10	150	0.028	16	15.0	11	12.0	28
25	3/4		16	RV0TIP25C	10	100	0.046	19	16.3	14	16.7	34
32	1		16	RV0TIP32D	10	130	0.076	22	19.1	17	19.9	42
40	1 1/4		16	RV0TIP40E	90	-	0.120	26	21.4	21	25.6	51
50	1 1/2		16	RV0TIP50F	50	-	0.200	31	21.4	26	35.6	61
63	2		16	RV0TIP63G	25	-	0.355	38	25.7	33	45.3	75
75	2 1/2	2 1/2	16	RV0TIP75H	35	-	0.540	44	30.2	39	52.8	89
90	3		16	RV0TIP90I	24	-	0.850	51	33.3	47	64.7	106
110	4		16	RV0TIP91L	14	-	1.440	61	39.3	57	78.7	129

PF 2 01 951 011

Plain/threaded elbow 90° Rp PVC-U

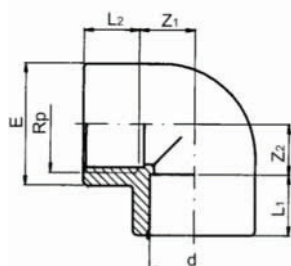

d [mm]	Rp [inch]	d [inch]	PN	Code	SP	GP	kg	L1 [mm]	L2 [mm]	Z1 [mm]	Z2 [mm]	E [mm]
16	3/8		16	RV0GOP16A	10	360	0.013	14.0	11.4	9.0	11.6	23
20	1/2		16	RV0GOP20B	10	200	0.021	16.0	15.0	11.0	12.0	28
25	3/4		16	RV0GOP25C	10	160	0.034	19.0	16.3	14.0	16.7	34
32	1		16	RV0GOP32D	10	80	0.056	22.0	19.1	17.0	19.9	42
40	1 1/4		16	RV0GOP40E	130	-	0.093	26.0	21.4	21.0	25.6	51
50	1 1/2		16	RV0GOP50F	80	-	0.160	31.0	21.4	26.0	35.6	61
63	2		16	RV0GOP63G	40	-	0.275	38.0	25.7	33.0	45.3	75
75	2 1/2	2 1/2	16	RV0GOP75H	50	-	0.420	44.0	30.2	39.0	52.8	89
90	3		16	RV0GOP90I	30	-	0.710	51.0	33.3	47.0	64.7	106
110	4		16	RV0GOP91L	17	-	1.065	61.0	39.3	57.0	78.7	129

PF 2 01 951 011

Plain/threaded socket Rp PVC-U

• (*) Without octagon

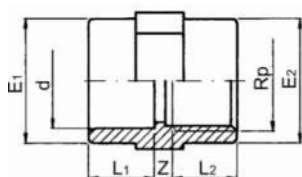

d [mm]	Rp [inch]	d [inch]	PN	Code	SP	GP	kg	L1 [mm]	L2 [mm]	Z1 [mm]	E1 [mm]	E2 [mm]
16	3/8		16	RV0MAP16A	10	500	0.010	14.0	11.4	6.0	23.0	23.0
20	1/2		16	RV0MAP20B	10	250	0.017	16.0	15.0	6.0	28.0	28.0
25	3/4		16	RV0MAP25C	10	200	0.024	19.0	16.3	6.0	34.0	34.0
32	1		16	RV0MAP32D	10	130	0.042	22.0	19.1	6.0	42.0	42.0
40	1 1/4		16	RV0MAP40E	100	-	0.060	26.0	21.4	4.0	51.0	51.0
50	1 1/2		16	RV0MAP50F	60	-	0.087	31.0	21.4	7.0	61.0	58.0
63	2		16	RV0MAP63G	80	-	0.134	38.0	25.7	7.0	75.0	72.0
75	2 1/2	2 1/2	16	RV0MAP75H	110	-	0.215	44.0	30.2	8.0	89.0	89.0
90	3		16	RV0MAP90I	64	-	0.345	51.0	33.3	9.0	106.0	103.0
110	4		16	RV0MAP91L	35	-	0.550	61.0	39.3	10.0	129.0	130.0
* 125	5		16	RV0MAP92N	16	-	1.060	69.0	43.6	51.0	160.0	
* 140	5	5	16	RV0MAP93N	9	-	1.120	76.0	43.6	40.0	162.0	
* 160	6		16	RV0MAP94O	9	-	1.400	86.0	48.0	46.0	184.0	

PF 2 01 951 011

Plain/threaded union with o-ring Rp PVC-U

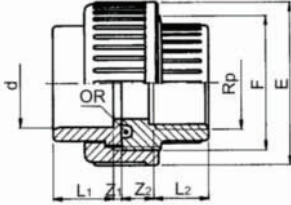

PF 2 01 951 011

d [mm]	Rp [inch]	d [inch]	PN	EPDM Code	SP	GP	kg	L1 [mm]	L2 [mm]	Z1 [mm]	Z2 [mm]	F [inch]	E [mm]
16	3/8		16	RV0BOP16A	10	250	0.031	14.0	11.4	3.0	13.6	3/4	34
20	1/2		16	RV0BOP20B	10	150	0.042	16.0	15.0	3.0	11.0	1	42
25	3/4		16	RV0BOP25C	10	100	0.070	19.0	16.3	3.0	12.7	1 1/4	52
32	1		16	RV0BOP32D	10	60	0.094	22.0	19.1	3.0	12.9	1 1/2	59
40	1 1/4		16	RV0BOP40E	90	-	0.155	26.0	21.4	3.0	16.6	2	72
50	1 1/2		16	RV0BOP50F	60	-	0.237	31.0	21.4	3.0	23.6	2 1/4	79
63	2		16	RV0BOP63G	36	-	0.382	38.0	25.7	3.0	30.3	2 3/4	96
75	2 1/2	2 1/2	16	RV0BOP75H	20	-	0.625	44.0	30.2	3.0	31.8	3 1/2	119
90	3		16	RV0BOP90I	15	-	0.865	51.0	33.3	5.0	35.7	4	134
110	4		16	RV0BOP91L	18	-	1.340	61.0	39.3	5.0	39.7	5	163

Threaded adaptor R PVC-U 3 diameters

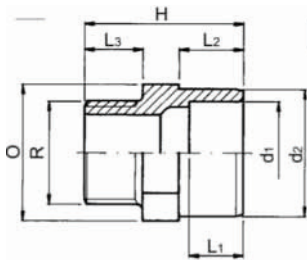

PF 2 01 951 011

d-d [mm]	R [inch]	PN	Code	SP	GP	kg	L1 [mm]	L2 [mm]	L3 [mm]	H [mm]	O [mm]
16 - 16	3/8	16	RV0AMP12A	100	600	0.008		14	11.4	36	22
16 - 20	3/8	16	RV0AMP16A	100	500	0.009	14.0	16	11.4	40	24
16 - 20	1/2	16	RV0AMP16B	100	400	0.010	14.0	16	15.0	43	24
20 - 25	3/8	16	RV0AMP20A	100	300	0.014	16.0	19	11.4	43	30
20 - 25	1/2	16	RV0AMP20B	100	300	0.014	16.0	19	15.0	46	30
20 - 25	3/4	16	RV0AMP20C	100	300	0.015	16.0	19	16.3	47	30
25 - 32	1/2	16	RV0AMP25B	100	200	0.025	19.0	22	15.0	49	36
25 - 32	3/4	16	RV0AMP25C	100	200	0.026	19.0	22	16.3	50	36
25 - 32	1	16	RV0AMP25D	100	200	0.029	19.0	22	19.1	53	36
32 - 40	3/4	16	RV0AMP32C	10	140	0.036	22.0	26	16.3	54	46
32 - 40	1	16	RV0AMP32D	10	120	0.040	22.0	26	19.1	57	46
32 - 40	1 1/4	16	RV0AMP32E	10	100	0.049	22.0	26	21.4	60	46
40 - 50	1	16	RV0AMP40D	90	-	0.070	26.0	31	19.1	64	55
40 - 50	1 1/4	16	RV0AMP40E	50	-	0.075	26.0	31	21.4	67	55
40 - 50	1 1/2	16	RV0AMP40F	80	-	0.074	26.0	31	21.4	67	55
50 - 63	1 1/4	16	RV0AMP50E	50	-	0.116	31.0	38	21.4	74	65
50 - 63	1 1/2	16	RV0AMP50F	110	-	0.113	31.0	38	21.4	74	65
50 - 63	2	16	RV0AMP50G	100	-	0.125	31.0	38	25.7	78	65
63 - 75	1 1/2	16	RV0AMP63F	35	-	0.145	38.0	44	21.4	80	80
63 - 75	2	16	RV0AMP63G	70	-	0.150	38.0	44	25.7	84	80
63 - 75	2 1/2	16	RV0AMP63H	50	-	0.170	38.0	44	30.2	91	80
75 - 90	2	16	RV0AMP75G	54	-	0.270	44.0	51	25.7	94	95
75 - 90	2 1/2	16	RV0AMP75H	60	-	0.275	44.0	51	30.2	99	95
75 - 90	3	16	RV0AMP75I	36	-	0.285	44.0	51	33.3	102	95
90 - 110	2 1/2	16	RV0AMP90H	25	-	0.470	51.0	61	30.2	110	115
90 - 110	3	16	RV0AMP90I	25	-	0.486	51.0	61	33.3	113	115
90 - 110	4	16	RV0AMP90L	16	-	0.485	51.0	61	39.3	118	115
110 - 125	3	10	RV0AMP91I	40	-	0.490	61.0	66	33.3	115	130
110 - 125	4	10	RV0AMP91L	32	-	0.492	61.0	66	39.3	120	130
110 - 125	5	10	RV0AMP91N	32	-	0.535	61.0	66	40.0	120	130
125 - 140	5	10	RV0AMP92N	24	-	0.740	69.0	71	74.0	145	

Threaded adaptor R PVC-U 2 diameters

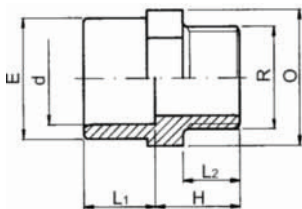

PF 2 01 951 011

d [mm]	R [inch]	d [inch]	PN	Code	SP	GP	kg	L1 [mm]	L2 [mm]	E [mm]	L [mm]	O [mm]
75	2 ½	2 ½	16	RV0ADP75H	72	-	0.210	44	30.2	89	42	90
90	3		16	RV0ADP90I	40	-	0.336	51	33.3	106	46	110
110	4		16	RV0ADP91L	35	-	0.530	61	39.3	129	51	130

Threaded adaptor Rp PVC-U

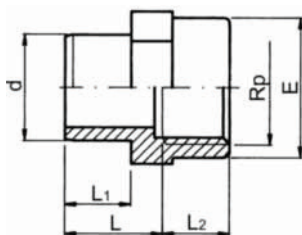

PF 2 01 951 011

d [mm]	Rp [inch]	d [inch]	PN	Code	SP	GP	kg	L1 [mm]	L2 [mm]	E [mm]	L [mm]
16	¾		16	RV0AFP16A	10	600	0.016	14	11.4	23	22
20	½		16	RV0AFP20B	10	300	0.017	16	15.0	28	24
20	¾		16	RV0AFP20C	10	240	0.024	16	16.3	34	24
25	½		16	RV0AFP25B	10	220	0.019	19	15.0	28	27
25	¾		16	RV0AFP25C	10	200	0.026	19	16.3	34	27
25	1		16	RV0AFP25D	10	140	0.039	19	19.1	42	27
32	¾		16	RV0AFP32C	10	180	0.032	22	16.3	34	30
32	1		16	RV0AFP32D	10	120	0.041	22	19.1	42	30
40	1		16	RV0AFP40D	100	-	0.050	26	19.1	42	36
40	1 ¼		16	RV0AFP40E	90	-	0.065	26	21.4	51	36
50	1 ¼		16	RV0AFP50E	70	-	0.070	31	21.4	51	41
50	1 ½		16	RV0AFP50F	60	-	0.080	31	21.4	58	41
50	2		16	RV0AFP50G	100	-	0.122	31	25.7	72	41
63	2		16	RV0AFP63G	80	-	0.135	38	25.7	72	48
75	2		16	RV0AFP75G	72	-	0.175	44	25.7	72	53
75	2 ½	2 ½	16	RV0AFP75H	90	-	0.225	44	30.2	89	58
75	3		16	RV0AFP75I	100	-	0.295	44	33.3	103	58
90	2 ½		16	RV0AFP90H	90	-	0.275	51	30.2	89	65
90	3		16	RV0AFP90I	60	-	0.310	51	33.3	103	65
90	4		16	RV0AFP90L	52	-	0.450	51	39.3	130	65
110	3		16	RV0AFP91I	52	-	0.385	61	33.3	103	76
110	4		16	RV0AFP91L	45	-	0.480	61	39.3	130	76

Plain threaded union R PVC-U

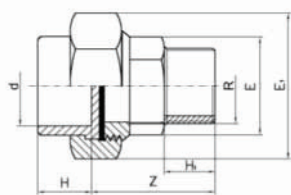

PF 2 01 951 011

d [mm]	R [inch]	PN	Code	SP	GP	kg	L [mm]	L1 [mm]	H [mm]	Z [mm]	F [inch]	E [mm]
25	¾	16	RV0BMP25C	10	100	0.078	19	16.3	44	3	1 ¼	52
32	1	16	RV0BMP32D	40	-	0.102	22	19.1	48	3	1 ½	59
40	1 ¼	16	RV0BMP40E	40	-	0.163	26	21.4	54	3	2	72
50	1 ½	16	RV0BMP50F	60	-	0.220	31	22.0	58	3	2 ¼	79
50	2	16	RV0BMP50G	60	-	0.260	31	26.0	58	3	2 ¼	79
63	2	16	RV0BMP63G	36	-	0.375	38	26.0	66	3	2 ¾	96

Union PVC-U/brass threaded Rp

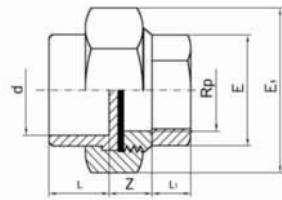

PF 2 01 950 013

d [mm]	Rp [inch]	PN	Code	SP	GP	kg	L [mm]	L1 [mm]	Z [mm]	E [mm]	E1 [mm]
16	3/8	16	RV0BMF16A	170	-	0.085	14	11	10	20	30.0
20	1/2	16	RV0BMF20B	70	-	0.145	16	15	11	25	38.0
25	3/4	16	RV0BMF25C	50	-	0.215	19	15	14	32	47.0
32	1	16	RV0BMF32D	40	-	0.280	22	16	12	38	55.0
40	1 1/4	16	RV0BMF40E	25	-	0.380	26	19	13	48	65.0
50	1 1/2	16	RV0BMF50F	25	-	0.485	31	21	13	54	72.0
63	2	16	RV0BMF63G	15	-	1.200	38	25	14	66	88.0

Union PVC-U/brass threaded R

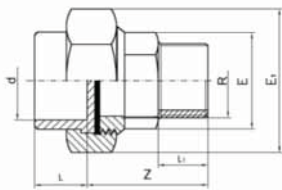

PF 2 01 950 013

d [mm]	R [inch]	PN	Code	SP	GP	kg	L [mm]	L1 [mm]	Z [mm]	E [mm]	E1 [mm]
16	3/8	16	RV0BMM16A	115	-	0.110	14	11	35	20	30.0
20	1/2	16	RV0BMM20B	95	-	0.165	16	12	41	25	38.0
25	3/4	16	RV0BMM25C	50	-	0.245	19	15	45	32	47.0
32	1	16	RV0BMM32D	40	-	0.325	22	19	47	38	55.0
40	1 1/4	16	RV0BMM40E	25	-	0.460	26	21	55	48	65.0
50	1 1/2	16	RV0BMM50F	24	-	0.610	31	21	57	54	72.0
63	2	16	RV0BMM63G	15	-	0.975	38	25	68	66	88.0

Adaptor socket Rp PVC-U 3 diameters

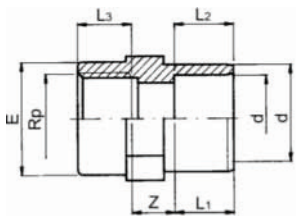

PF 2 01 951 011

d-d [mm]	Rp [inch]	PN	Code	SP	GP	kg	L1 [mm]	L2 [mm]	L3 [mm]	Z [mm]	E [mm]
20 - 25	1/2	16	RV0MFP25B	10	200	0.015	16	19	15.0	12	28
25 - 32	3/4	16	RV0MFP32C	10	150	0.027	19	22	16.3	13	34
32 - 40	1	16	RV0MFP40D	130	-	0.050	22	26	19.1	14	42
40 - 50	1 1/4	16	RV0MFP50E	110	-	0.070	26	31	21.4	16	51
50 - 63	1 1/2	16	RV0MFP63F	80	-	0.120	31	38	21.4	18	58
63 - 75	2	16	RV0MFP75G	70	-	0.180	38	44	25.7	18	72
75 - 90	2 1/2	16	RV0MFP90H	90	-	0.284	44	51	30.2	21	89
90 - 110	3	16	RV0MFP91I	50	-	0.490	51	61	33.3	25	103

PVC-U adaptor fittings range

With metal ring reinforced

Threaded central offtake tee Rp PVC-U

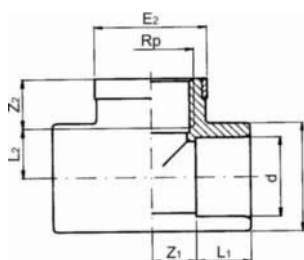

PF 2 01 951 012

d [mm]	Rp [inch]	PN	Code	SP	GP	kg	L1 [mm]	L2 [mm]	Z1 [mm]	Z2 [mm]	E1 [mm]	E2 [mm]
16	3/8	16	RV0TTP16A	10	280	0.018	14	11.4	9	11.6	23.0	25.0
20	1/2	16	RV0TTP20B	10	150	0.030	16	15.0	11	12.0	28.0	30.0
25	3/4	16	RV0TTP25C	10	100	0.048	19	13.3	14	16.7	34.0	35.0
32	1	16	RV0TTP32D	10	100	0.076	22	19.1	17	19.9	42.0	45.0
40	1 1/4	16	RV0TTP40E	80	-	0.124	26	21.4	21	25.6	51.0	55.0
50	1 1/2	16	RV0TTP50F	50	-	0.200	31	21.4	26	35.6	61.0	65.0
63	2	16	RV0TTP63G	20	-	0.365	38	25.7	33	45.3	75.0	75.0

Plain/threaded socket Rp PVC-U

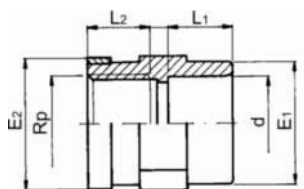

PF 2 01 951 012

d [mm]	Rp [inch]	PN	Code	SP	GP	kg	L1 [mm]	L2 [mm]	Z [mm]	E1 [mm]	E2 [mm]
16	3/8	16	RV0MMP16A	10	500	0.010	14	11.4	6	23.0	25.0
20	1/2	16	RV0MMP20B	10	250	0.020	16	15.0	4	28.0	30.0
25	3/4	16	RV0MMP25C	10	200	0.026	19	16.3	6	34.0	35.0
32	1	16	RV0MMP32D	10	120	0.044	22	19.1	6	42.0	45.0
40	1 1/4	16	RV0MMP40E	100	-	0.070	26	21.4	8	51.0	55.0
50	1 1/2	16	RV0MMP50F	60	-	0.092	31	21.4	13	61.0	65.0
63	2	16	RV0MMP63G	80	-	0.140	38	25.7	15	75.0	75.0

Plain/threaded elbow 90° Rp PVC-U

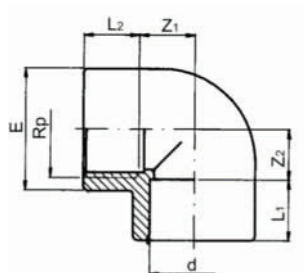

PF 2 01 951 012

d [mm]	Rp [inch]	PN	Code	SP	GP	kg	L1 [mm]	L2 [mm]	Z1 [mm]	Z2 [mm]	E1 [mm]	E2 [mm]
16	3/8	16	RV0GGP16A	10	360	0.014	14	11.4	9	11.6	23.0	25.0
20	1/2	16	RV0GGP20B	10	200	0.021	16	15.0	11	12.0	28.0	30.0
25	3/4	16	RV0GGP25C	10	160	0.038	19	16.3	14	16.7	34.0	35.0
32	1	16	RV0GGP32D	10	80	0.062	22	19.1	17	19.9	42.0	45.0
40	1 1/4	16	RV0GGP40E	130	-	0.095	26	21.4	21	25.6	51.0	55.0
50	1 1/2	16	RV0GGP50F	70	-	0.160	31	21.4	26	35.6	61.0	65.0
63	2	16	RV0GGP63G	40	-	0.290	38	25.7	33	45.3	75.0	75.0