



WATER HEATERS
2008



Prices are net from VAT.

Recourse to the Italian Law - SIENA COURT in case of controversy shall apply.



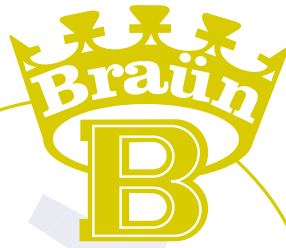

TITANIUM
powered

GLASS ENAMELLED
made in italy



The reason of a choice.

Bandini is producing for more than 45 years electric storage water heaters and after all these years we gained a remarkable experience on how to build an excellent product.

We know for sure that the critical point of a water heater is the PROTECTION OF THE WATER TANK AGAINST LEAKINGS.

Up to now, according to the development of the technologies, we have applied the glass enamelled layer and cathodic protection. We have been very happy by this technology but we wanted more and we had it !!

OUR NEW GLASS ENAMEL LAYER HAS BEEN ENRICHED WITH TITANIUM CHEMICAL COMPONENTS

Mr. Water Heater



PERFORMANCES GUARANTEED
LOW CONSUMPTION of ENERGY
RELIABLE IN TIME

ALL THIS THANKS TO 50 YEARS EXPERIENCE DUE TO BANDINI RESEARCHES AND TECHNOLOGY

INNER TANK

Manufactured with 1st choice plate, submitted to a double pressure test 100%, to put in evidence any loose welding. Resistance Test up-to 16 Bar.

STEEL PIPE

For the output of warm water

EXTERNAL PROTECTION

painting by hypossidric powders processed in oven.

INTERNAL PROTECTION

of inner tank by 250 microns of porcelain enamel layer of the best quality.

PORCELAIN TREATMENT

Constantly monitorized, according to rules DIN 4753.

THERMIC INSULATION

Compact features by means of polyurethane foam

CATHODIC PROTECTION

By means of magnesium anode, which guarantees lasting of the equipment by dissolving into the water

THERMOSTAT

With double function, adjustment of temperature and interruption of actioning in case of abnormal situations.

INSPECTION FLANGE

PROTECTED PLATED HEATING ELEMENT
in curved copper





THE BEST REPLY TO A GLOBAL NEED.

As a global player, BANDINI is distributing its products all around the world, from North to South, from East to West.

Installation conditions and water supply conditions can be very different from Country to Country. Water can come from mountains, from the well, from the water after desalination processes. But the quality has to be always the same: GOOD. TITANIUM POWERED WATER HEATERS IS OUR REPLY TO GIVE THE WORLD ONE GLOBAL QUALITY FOR A LONG LASTING WATER HEATER.

The new logo "titanium powered" will marks the new line of products. Same indication will be put on the box. We hope you will be happy and satisfied with our Water Heater





- **INNER TANK:** Glass lined protection.
- **Plated heating element** directly in contact with sanitary water.
- **Magnesium anode**
- **Double function thermostat:** regulation and safety
- **Insulation:** polyurethane foam
- **Safety valve:** WATER PRESSURE PROTECTION INCLUDED IN EVERY BOILER
- **OUTER REGULATION OF TEMPERATURE** (Standard)
- **Fix-on-the-wall Kit:** with Standard bracket for hanging

Model	H	L	P	
A-5 SP	mm 340	mm 250	mm 245	Oversink
A-5 ST	mm 340	mm 250	mm 245	Undersink

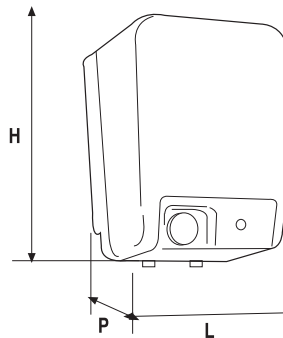
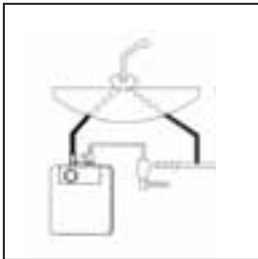

model A-5	Power watt	Tension volts	Max pressure bar	Heating time 50°C	Class of insulation	Protection against humidity	Packing dimensions
5 l	1500	230	8	12'	I	IPX4	290x400x260

model	code	barcode	description
2 YEARS GUARANTEE			
A-5 SP	SE0005R2P	8023945 002023	Lt.5 oversink outer reg.
A-5 ST	SE0005R2T	8023945 012022	Lt.5 undersink outer reg.
5 YEARS GUARANTEE			
A-5 SP	SE0005R5P	8023945 002054	Lt.5 oversink outer reg.
A-5 ST	SE0005R5T	8023945 012053	Lt.5 undersink outer reg.

ELECTRIC WATER HEATER

Lt.12/15

A12 SP - ST

A15 SP - ST



A12SP Oversink Automatic Thermostat
A12ST Undersink Automatic Thermostat

A12 SP TR Oversink Outer Regulation
A12 ST TR Undersink Outer Regulation

- **INNER TANK:** Glass lined protection.
- Plated heating element directly in contact with sanitary water.
- Magnesium anode
- Double function thermostat: regulation and safety
- Insulation: polyurethane foam
- Safety valve: **WATER PRESSURE PROTECTION INCLUDED IN EVERY BOILER**
- **OUTER REGULATION OF TEMPERATURE (Standard)**
- Fix-on-the-wall Kit: with Standard bracket for hanging

Model	H	L	P	
A12 SP	mm 410	mm 350	mm 220	Oversink
A12 ST	mm 410	mm 350	mm 220	Undersink
A15 SP	mm 400	mm 350	mm 260	Oversink
A15 ST	mm 400	mm 350	mm 260	Undersink

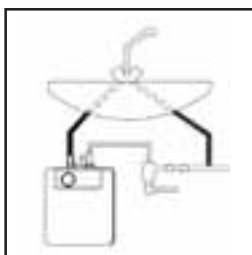

Model	Power watt	Tension volts	Max pressure bar	Heating time 50°C	Class of insulation	Protection against humidity	Packing dimensions
A12 SP	1500	230	8	25'	I	IPX4	470x390x250
A12 ST	1500	230	8	25'	I	IPX4	470x390x250
A15 SP	1500	230	8	30'	I	IPX4	470x400x290
A15 ST	1500	230	8	30'	I	IPX4	470x400x290

model	code	barcode	description
2 YEARS GUARANTEE			
A-12 SP	SE0012R2P	8023945 021222	Lt.12 oversink
A-12 ST	SE0012R2T	8023945 031221	Lt.12 undersink
A-12 SP TR	SE0012R2P001	8023945 071227	Lt.12 oversink outer regulation
A-12 ST TR	SE0012R2T001	8023945 081226	Lt.12 undersink outer regulation
A-15 SP	SE0015R2P	8023945 041220	Lt.15 oversink
A-15 ST	SE0015R2T	8023945 051229	Lt.15 undersink
A-15 SP TR	SE0015R2P001	8023945 151226	Lt.15 oversink outer regulation
A-15 ST TR	SE0015R2T001	8023945 161226	Lt.15 undersink outer regulation
5 YEARS GUARANTEE			
A-12 SP	SE0012R5P	8023945 021253	Lt.12 oversink
A-12 ST	SE0012R5T	8023945 031252	Lt.12 undersink
A-12 SP TR	SE0012R5P001	8023945 071258	Lt.12 oversink outer regulation
A-12 ST TR	SE0012R5T001	8023945 081257	Lt.12 undersink outer regulation
A-15 SP	SE0015R5P	8023945 041251	Lt.15 oversink
A-15 ST	SE0015R5T	8023945 051250	Lt.15 undersink
A-15 SP TR	SE0015R5P001	8023945 151257	Lt.15 oversink outer regulation
A-15 ST TR	SE0015R5T001	8023945 161256	Lt.15 undersink outer regulation

ELECTRIC WATER HEATER Lt.12

PLATINUM Q12

Q-12 SP oversink outer reg
Q-12 ST undersink outer reg,
Q-12 SP oversink outer reg.
Q-12 ST undersink outer reg,

NEW



- **INNER TANK:** Glass lined protection.
- **Plated heating element** directly in contact with sanitary water.
- **Magnesium anode**
- **Double function thermostat:** regulation and safety
- **Insulation:** polyurethane foam
- **Safety valve:** WATER PRESSURE PROTECTION INCLUDED IN EVERY BOILER
- **OUTER REGULATION OF TEMPERATURE (Standard)**
- **Fix-on-the-wall Kit:** with Standard bracket for hanging

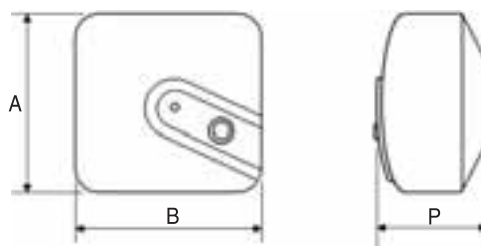

Model	A	B	P
PlatinumQ	350 mm	350 mm	260 mm

Models	Power <i>watt</i>	Tension <i>volts</i>	Max pressure <i>bar</i>	Heating time 50°C	Class of insulation	Protection against humidity	Packing dimensions
Q-12 SP	1500	230	8	25'	I	IPX4	397x392x296
Q-12 ST	1500	230	8	25'	I	IPX4	397x392x296

model	code	description
2 YEARS GUARANTEE		
Q-12 SP	SE0012Q2P001	Lt.12 oversink outer regulation
Q-12 ST	SE0012Q2P001	Lt.12 undersink outer regulation
5 YEARS GUARANTEE		
Q-12 SP	SE0012Q5P001	Lt.12 oversink outer regulation
Q-12 ST	SE0012Q5P001	Lt.12 undersink outer regulation



- **INNER TANK:** Glass lined protection.
- **Plated heating element** directly in contact with sanitary water.
- **Magnesium anode**
- **Double function thermostat:** regulation and safety
- **Safety valve:** WATER PRESSURE PROTECTION INCLUDED IN EVERY BOILER
- **Thermometer** with the indication of temperature.
- **MIXER**
- **FLEXIBLE PIPE, EQUIPPED WITH SHOWER GROUP AND SLIDING ROD**
- **Kit for assembling** equipped with Standard bracket for hanging

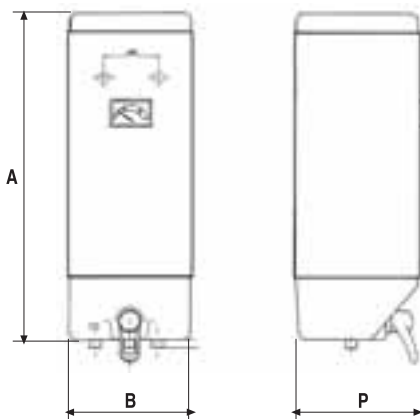

Model	A	B	P
B-14	mm 640	mm 230	mm 220

Mixer with single control

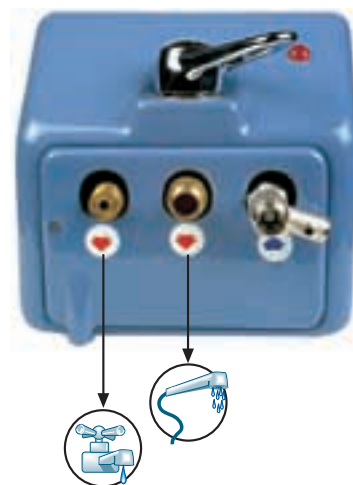

Mixer with single control

Double Outlet in order to allow contemporary more water supply sources mode.

Model	B 14	Power watt	Tension volts	Max pressure bar	Heating time 50°C	Class of insulation	Protection against humidity	Packing dimensions
14 l		2000	230	8	20'	I	IPX4	710x255x260

model	code	barcode	description
2 YEARS GUARANTEE			
B -14	SE0014R2V	8023945 062126	14 L shower with mixer



- **INNER TANK:** Glass lined protection.
- **Plated heating element** directly in contact with sanitary water.
- **Magnesium anode**
- **Double function thermostat:** regulation and safety
- **Insulation:** polyurethane foam
- **Safety valve:** WATER PRESSURE PROTECTION INCLUDED IN EVERY BOILER
- **OUTER REGULATION OF TEMPERATURE** (Standard)
- **Fix-on-the-wall Kit:** with Standard bracket for hanging

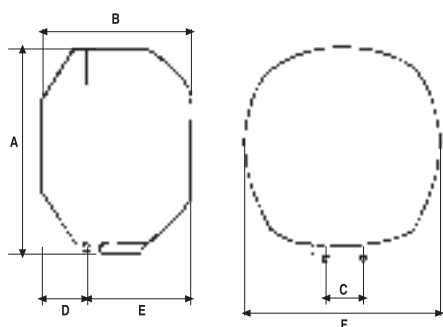

Model	A	B	C	D	E	F
B 30	mm 535	mm 325	mm 100	mm 12	mm 205	mm 460

Model B 30	Power watt	Tension volts	Max pressure bar	Heating time 50°C	Class of insulation	Protection against humidity	Packing dimensions
30 l	1500	230 a 50/60Hz	8	60'	I	IPX4	560x500x340
30 l	2500	230 a 50/60Hz	8	45'	I	IPX4	560x500x340

model	code	barcode	description
2 YEARS GUARANTEE			
B-30	SE0030E2V003	8023945 101221	30 L outer regulation
5 YEARS GUARANTEE			
B-30	SE0030E5V003	8023945 101252	30 L outer regulation

ELECTRIC WATER HEATER VERTICAL THERMO-ELECTRIC

Lt. 20 • 30 • 50 • 80 • 100 • 120 • 150 • 200

SE



- **INNER TANK:** Glass lined protection.
- **Plated heating element** directly in contact with sanitary water
- **Magnesium anode**
- **Double function thermostat:** regulation and safety
- **Insulation:** polyurethane foam
- **Safety valve:** WATER PRESSURE PROTECTION
INCLUDED IN EVERY BOILER

Vertical Series SE:
SE-20 / SE-30 / SE-50 / SE-80 / SE-100 / SE-120 / SE-150 / SE-200

Thermo Electric Series ST:
ST-50 / ST-80 / ST-100 / ST-120 / ST-150 / ST-200

Model	A	B	C	F	G	I	L
SE-20	400	350	100	120	250	65	-
SE-30	450	370	100	120	250	65	-
SE-50	520	460	100	130	320	130	-
SE-80	730	460	100	130	320	130	240
SE-100	890	460	100	130	320	130	240
SE-120	1090	460	100	130	320	130	240
SE-150	1050	550	140	220	320	130	285
SE-200	1250	550	140	220	320	130	285

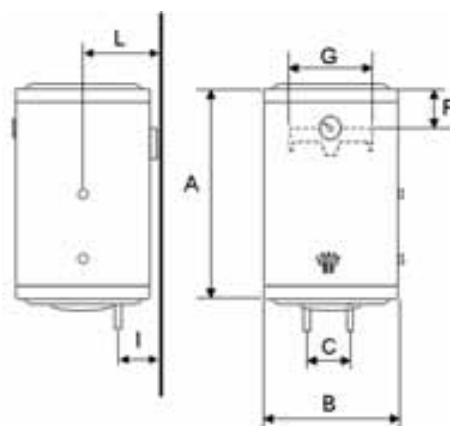

Model	Power watt	Tension volts	Heating time 50°C bar	Max pressure	Class of insulation	Protection against humidity	Packing dimensions
SE							
SE 20	1200	230	50'	8	I	IPX4	500x380x380
SE 30	1200	230	1h 10'	8	I	IPX4	595x380x380
SE 50	1200	230	2h 20'	8	I	IPX4	590x480x500
SE 80	1200	230	3h 20'	8	I	IPX4	775x480x500
SE 100	1500	230	3h 50'	8	I	IPX4	920x480x500
SE 120	1500	230	4h 00'	8	I	IPX4	1100x480x500
SE 150	2000	230	4h 50'	8	I	IPX4	1060x570x570
SE 200	2000	230	5h 00'	8	I	IPX4	1260x570x570

model	code	barcode	description
2 YEARS GUARANTEE			
SE-20	SE0020C2V	8023945 110322	20 L vertical
SE-30	SE0030C2V	8023945 120321	30 L vertical
SE-50	SE0050C2V	8023945 200320	50 L vertical
SE-80	SE0080C2V	8023945 300327	80 L vertical
SE-100	SE0100C2V	8023945 401222	100 L vertical
SE-120	SE0120C2V	8023945 461230	120 L vertical
SE-150	SE0150C2V	8023945 502127	150 L vertical
SE-200	SE0200C2V	8023945 562121	200 L vertical
5 YEARS GUARANTEE			
SE-20	SE0020C5V	8023945 110353	20 L vertical
SE-30	SE0030C5V	8023945 120352	30 L vertical
SE-50	SE0050C5V	8023945 200351	50 L vertical
SE-80	SE0080C5V	8023945 300358	80 L vertical
SE-100	SE0100C5V	8023945 401253	100 L vertical
SE-120	SE0120C5V	8023945 461257	120 L vertical
SE-150	SE0150C5V	8023945 502158	150 L vertical
SE-200	SE0200C5V	8023945 562152	200 L vertical

ELECTRIC WATER HEATER VERTICAL SE-TR

Lt. 30 • 50 • 80 • 100

SE-TR



- **INNER TANK:** Glass lined protection.
- **Plated heating element** directly in contact with sanitary water.
- **Magnesium anode**
- **Double function thermostat:** regulation and safety
- **Insulation:** polyurethane foam
- **Safety valve:** **WATER PRESSURE PROTECTION INCLUDED IN EVERY BOILER**

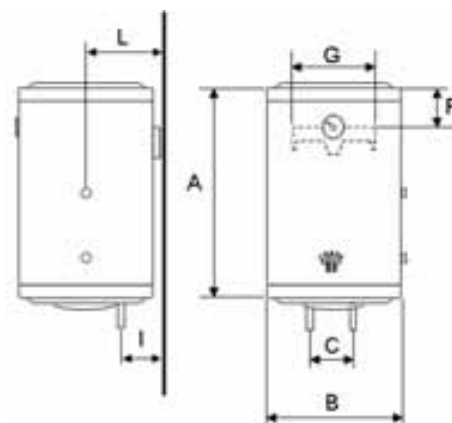

Model	A	B	C	F	G	I	L
SE-TR 30	450	370	100	120	250	65	-
SE-TR 50	520	460	100	130	320	130	-
SE-TR 80	730	460	100	130	320	130	240
SE-TR 100	890	460	100	130	320	130	240

Models	Power	Tension	Heating time	Max pressure	Class of insulation	Protection against humidity	Packing dimensions
	watt	volts	50 °C bar				
SE-TR 30	1200	230	1h 10'	8 bar	I	IPX4	595x380x380
SE-TR 50	1200	230	2h 20'	8 bar	I	IPX4	590x480x500
SE-TR 80	1200	230	3h 20'	8 bar	I	IPX4	775x480x500
SE-TR 100	1500	230	3h 50'	8 bar	I	IPX4	920x480x500

model	code	barcode	description
2 YEARS GUARANTEE			
SE-30 TR	SE0030C5V002	8023945 128358	30 L vertical outer reg.
SE-50 TR	SE0050C5V007	8023945 208357	50 L vertical outer reg.
SE-80 TR	SE0080C5V008	8023945 308354	80 L vertical outer reg.
SE-100 TR	SE0100C5V010	8023945 408450	100 L vertical outer reg.

ELECTRIC WATER HEATER VERTICAL ST

Lt. 50 • 80 • 100 • 120 • 150 • 200

ST

*THERMO-ELECTRIC VERSION:
available with right or left connections
o the central heating system*

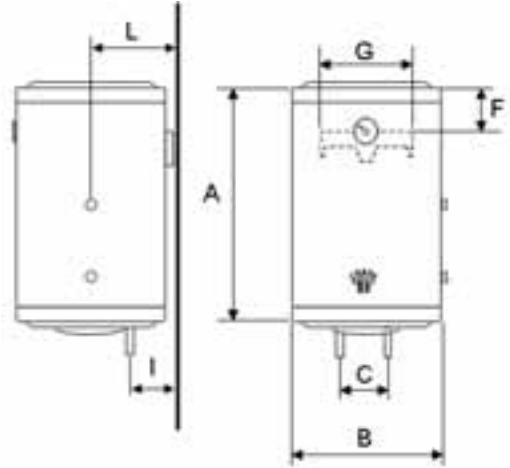

Models	A	B	C	D	E	F	G	I	L
ST-50	520	460	100	190	175	130	320	130	240
ST-80	730	460	100	390	265	130	320	130	240
ST-100	890	460	100	540	265	130	320	130	240
ST-120	1090	460	100	665	265	130	320	130	240
ST-150	1050	550	140	510	350	220	320	130	285
ST-200	1250	550	140	740	350	220	320	130	285

Models	Power watt	Tension volts	Heating time 50°C bar	Max pressure	Class of insulation	Protection against humidity	Packing dimensions
ST-50	1200	230	2h 20'	8 bar	I	IPX4	590x480x500
ST-80	1200	230	3h 20'	8 bar	I	IPX4	775x480x500
ST-100	1500	230	3h 50'	8 bar	I	IPX4	920x480x500
ST-120	1500	230	4h 00'	8 bar	I	IPX4	1100x480x500
ST-150	2000	230	4h 50'	8 bar	I	IPX4	1060x570x570
ST-200	2000	230	5h 00'	8 bar	I	IPX4	1260x570x570

model	code	barcode	description
2 YEARS GUARANTEE			
ST-50	ST0050C2V	8023945 220229	50 l indirect thermo electric
ST-80	ST0080C2V	8023945 320226	80 l indirect thermo electric
ST-100	ST0100C2V	8023945 420223	100 l indirect thermo electric
ST-120	ST0120C2V	8023945 461260	120 l indirect thermo electric
ST-150	ST0150C2V	8023945 520220	150 l indirect thermo electric
ST-200	ST0200C2V	8023945 580224	200 l indirect thermo electric
5 YEARS GUARANTEE			
ST-50	ST0050C5V	8023945 220359	50 l indirect thermo electric
ST-80	ST0080C5V	8023945 320356	80 l indirect thermo electric
ST-100	ST0100C5V	8023945 421251	100 l indirect thermo electric
ST-120	ST0120C5V	8023945 471256	120 l indirect thermo electric
ST-150	ST0150C5V	8023945 522156	150 l indirect thermo electric
ST-200	ST0200C5V	8023945 622153	200 l indirect thermo electric

ELECTRIC WATER HEATER
HORIZONTAL
THERMO-HORIZONTAL

Lt. 50 • 80 • 100 • 150 • 200

SO-SO/T



- **INNER TANK:** Glass lined protection.
- **Plated heating element directly in contact with sanitary water.**
- **Magnesium anode**
- **Double function thermostat: regulation and safety**
- **Insulation: polyurethane foam**
- **Safety valve: WATER PRESSURE PROTECTION INCLUDED IN EVERY BOILER**

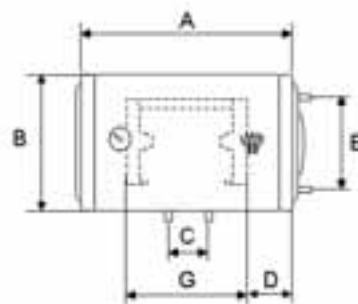
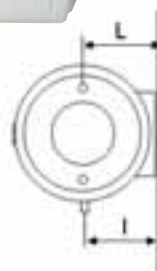

Models	A	B	C	D	E	F	G	I	L	M	O
SO-SO/T-50	520	460	100	-	-	-	-	-	-	180	160
SO-SO/T-80	730	460	100	-	-	-	-	-	-	180	160
SO-SO/T-100	890	460	100	-	280	-	-	-	-	390	160
SO-SO/T-120	1050	460	100	-	280	-	-	-	-	440	320
SO-SO/T-150	1250	550	140	-	365	-	-	-	-	480	350
SO-SO/T-200	1520	550	140	-	365	-	-	-	-	680	350

Models	Power watt	Tension volts	Heating time 50°C bar	Max pressure	Class of insulation	Protection against humidity	Packing dimensions
SO-SO/T-50	1200	230	2h 20'	8 bar	I	IPX4	590x480x500
SO-SO/T-80	1200	230	3h 20'	8 bar	I	IPX4	775x480x500
SO-SO/T-100	1500	230	3h 50'	8 bar	I	IPX4	920x480x500
SO-SO/T-120	1500	230	4h 00'	8 bar	I	IPX4	1100x480x500
SO-SO/T-150	2000	230	4h 50'	8 bar	I	IPX4	1060x570x570
SO-SO/T-200	2000	230	5h 00'	8 bar	I	IPX4	1260x570x570

model	code	barcode	description
2 YEARS GUARANTEE			
SO-50	SE0050C2O	8023945 210329	50 L horizontal
SO-80	SE0080C2O	8023945 310326	80 L horizontal
SO-100	SE0100C2O	8023945 411221	100 L horizontal
SO-120	SE0120C2O	8023945 461128	120 L horizontal
SO-150	SE0150C2O	8023945 512126	150 L horizontal
SO-200	SE0200C2O	8023945 572120	200 L horizontal
5 YEARS GUARANTEE			
SO-50	SE0050C5O	8023945 210350	50 L horizontal
SO-80	SE0080C5O	8023945 310357	80 L horizontal
SO-100	SE0100C5O	8023945 410354	100 L horizontal
SO-120	SE0120C5O	8023945 461140	120 L horizontal
SO-150	SE0150C5O	8023945 512157	150 L horizontal
SO-200	SE0200C5O	8023945 612154	200 L horizontal
5 YEARS GUARANTEE			
SO/T-80	ST0080C5O	8023945 330355	80 L horizontal thermo electric
SO/T-100	ST0100C5O	8023945 431250	100 L horizontal thermo electric
SO/T-120	ST0120C5O	8023945 481255	120 L horizontal thermo electric
SO/T-150	ST0150C5O	8023945 532155	150 L horizontal thermo electric
SO/T-200	ST0200C5O	8023945 632152	200 L horizontal thermo electric

FLOOR MOUNTED ELECTRIC VERTICAL WATER HEATERS

Lt. 150 • 200 • 300 • 400
500 • 600 • 800 • 1000

EP



- **INNER TANK:** Glass lined protection.
- **Plated heating element** directly in contact with sanitary water.
- **Magnesium anode**
- **Double function thermostat:** regulation and safety
- **Insulation:** polyurethane foam
- **RECIRCULATION CONNECTION**
- **DRAINAGE OUTLET**

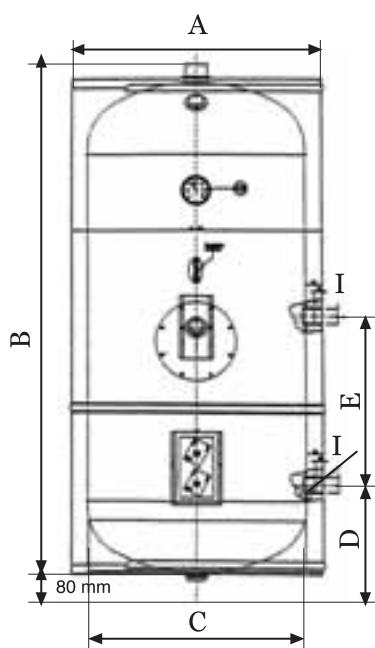

Model	A	B	C	D	E	I
EP-150	540 mm	1150 mm	480 mm	280 mm	260 mm	3/4
EP-200	540 mm	1350 mm	480 mm	280 mm	380 mm	3/4
EP-300	700 mm	1450 mm	600 mm	360 mm	470 mm	1" 1/4
EP-400	750 mm	1580 mm	650 mm	360 mm	470 mm	1" 1/4
EP-500	750 mm	1780 mm	650 mm	360 mm	600 mm	1" 1/4
EP-600	800 mm	1900 mm	700 mm	360 mm	600 mm	1" 1/4
EP-800	1000 mm	1870 mm	900 mm	370 mm	600 mm	1" 1/4
EP-1000	1000 mm	2150 mm	900 mm	370 mm	600 mm	1" 1/4

Model	Litres	Watt	Volts	Time from 15-45 °C min.	Water prod. from 15-45 °C l/h	Capacity l/h
EP-150	150	2000	230	90	80	950
EP-200	200	2000	230	100	90	1100
EP-300	300	3000	230-380	185	110	1200
EP-400	400	4000	230-380	191	125	1290
EP-500	500	5000	230-380	215	139	1300
EP-600	600	6000	230-380	215	167	1820
EP-800	800	8000	380	215	223	2200
EP-1000	1000	10000	380	215	280	2250

model	code	barcode	description
2 YEARS GUARANTEE			
EP-150	SN0150C2V001	8023945 502226	150 L pavement
EP-200	SN0200C2V002	8023945 562220	200 L pavement
EP-300	SN0300C2V003	8023945 568222	300 L pavement
EP-400	SN0400C2V004	8023945 562229	400 L pavement
EP-500	SN0500C2V005	8023945 570225	500 L pavement
EP-600	SN0600C2V006	8023945 570324	600 L pavement
EP-800	SN0800C2V007	8023945 571222	800 L pavement
EP-1000	SN1000C2V008	8023945 580224	1000 L pavement

GAZ STORAGE VERTICAL WATER HEATER

Lt. 50 • 80 • 100 • 120

GAVP

- INNER TANK: Glass lined protection.
- European valve with gas regulation and safety thermostat
- Smoke sensor device
- Thermometer

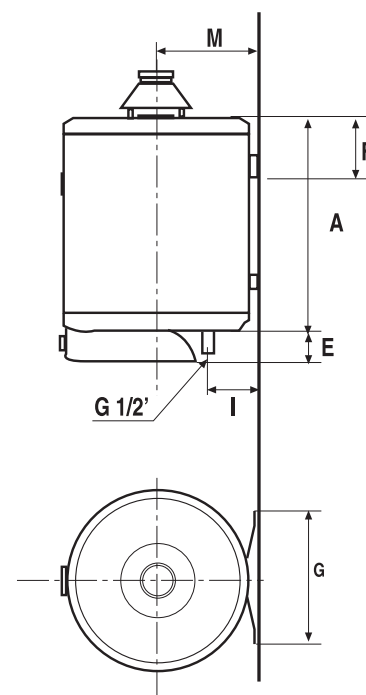
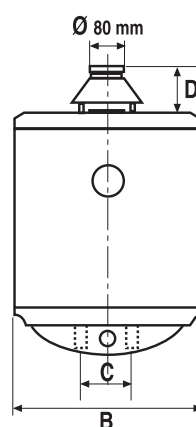

Dimensions

Modelli	A	B	C	D	E	F	G	I	M
GAVP 50	mm 495	mm 460	mm 100	mm 120	mm 75	mm 150	mm 350	mm 80	mm 243
GAVP 80	mm 7050	mm 460	mm 100	mm 120	mm 75	mm 150	mm 350	mm 80	mm 243
GAVP 100	mm 795	mm 460	mm 100	mm 120	mm 75	mm 150	mm 350	mm 80	mm 243
GAVP 120	mm 975	mm 460	mm 100	mm 120	mm 75	mm 150	mm 350	mm 80	mm 243

Technical Features:

Max Working pressure 6 bar

Type B11 bs

I12H3+

Model	Litres	Nozzles (mmx100)				Nominal Power kW	Power kW
		G20 pn20 mbar		G30-31pn 28-30/37mbar			
		Burner	Pilot	Burner	Pilot		
GAVP 50	50	2	0,4	1,15	0,21	3,8	3,3
GAVP 80	80	2	0,4	1,15	0,21	5,3	4,8
GAVP 100	100	2	0,4	1,15	0,21	5,3	4,8
GAVP 120	120	2	0,4	1,15	0,21	5,6	5,0

model	code	barcode	description
3 YEARS GUARANTEE			
GAVP-50	SA0050C3A	8023945 206032	LT. 50 GAS
GAVP-80	SA0080C3A	8023945 307036	LT. 80 GAS
GAVP-100	SA0100C3A	8023945 407033	LT. 100 GAS
GAVP-120	SA0120C3A	8023945 467037	LT. 120 GAS

GAZ STORAGE WATER HEATER FLOOR MOUNTED

Lt. 150 • 200 • 300 • 400 • 500 • 800 • 1000

GIVP



- INNER TANK: Glass lined protection.
- European valve with gas regulation and safety thermostat
- Smoke sensor device
- Thermometer

Model	Nominal Power	Power
	kW	kW
GIVP 150	10	8,2
GIVP 200	10	8,2
GIVP 300	17,4	14,6
GIVP 400	23,7	19,9
GIVP 500	23,7	19,9
GIVP 800	37,0	32,5
GIVP 1000	37,0	32,5

Dimensions

Model	A	B	C	D	E	G	I	L	M	N	P	U
GIVP 150	mm 1500	mm 1200	mm 540	mm 480	mm 360	mm 1230	mm 100	mm 100	mm 400	3/4"	3/4"	1/2"
GIVP 200	mm 1500	mm 1400	mm 540	mm 480	mm 360	mm 1430	mm 100	mm 100	mm 400	3/4"	3/4"	1/2"
GIVP 300	mm 1735	mm 1535	mm 700	mm 600	mm 390	mm 1230	mm 140	mm 100	mm 630	1 1/4"	1 1/4"	3/4"
GIVP 400	mm 1730	mm 1540	mm 750	mm 650	mm 400	mm 1290	mm 140	mm 100	mm 630	1 1/4"	1 1/4"	3/4"
GIVP 500	mm 2000	mm 1790	mm 750	mm 650	mm 400	mm 1530	mm 140	mm 100	mm 630	1 1/4"	1 1/4"	3/4"
GIVP 800	mm 2000	mm 1800	mm 990	mm 900	mm 460	mm 1440	mm 160	mm 120	mm 710	1 1/4"	1 1/4"	3/4"
GIVP 1000	mm 2220	mm 2020	mm 990	mm 900	mm 460	mm 1680	mm 160	mm 120	mm 720	1 1/4"	1 1/4"	3/4"

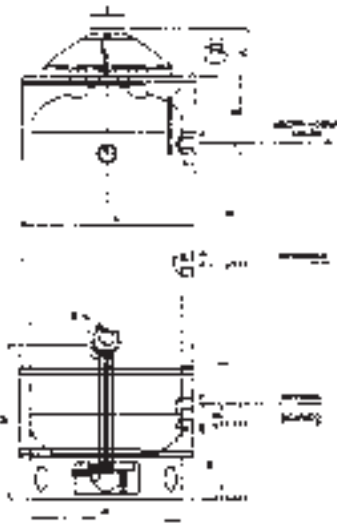

Technical Features: Type B11 bs

II2H3+

Max Working pressure 6 bar

Burner

Model	150	200	300	400	500	800	1000
G20 pn20 mbar	2,4	2,4	3,45	4,10	4,10	4,20	4,20
G30-31 Pn28-30/37mbar	1,6	1,6	2	2,4	2,4	1,8x3	1,8x3

Pilot

Model	150	200	300	400	500	800	1000
G20 pn20 mbar	2x0,27	2x0,27	2x0,27	2x0,27	2x0,27	2x0,27	2x0,27
G30-31 Pn28-30/37mbar	0,22	0,22	0,22	0,22	0,22	0,22	0,22

model	code	barcode	description
2 YEARS GUARANTEE			
GIVP-150	SN0150C3V	8023945 507030	150 L pavement
GIVP-200	SN0200C3V	8023945 567034	200 L pavement
GIVP-300	SN0300C3V	8023945 568031	300 L pavement
GIVP-400	SN0400C3V	8023945 569038	400 L pavement
GIVP-500	SN0500C3V	8023945 570034	500 L pavement
GIVP-800	SN0800C3V	8023945 571031	800 L pavement
GIVP-1000	SN1000C3V	8023945 580033	1000 L pavement

FLOOR MOUNTED WOOD
AND WOOD-ELECTRIC
WATER HEATERS

L-LE-LTE



L= WOOD
L-E= WOOD / WOOD-ELECTRIC
LTE= WOOD-THERMOELECTRIC

- Plated heating element directly in contact with sanitary water. (LE-LTE)
- Double function thermostat: regulation and safety (LE-LTE)
- Safety valve: WATER PRESSURE PROTECTION INCLUDED IN EVERY BOILER
- Thermometer
- REFRACTORY OVEN, COVERED WITH OVEN-ENAMELLED META SHEET
- PIPE FOR OUTLET OF SMOKE; 80 mm Diameter

**Wood Water Heaters,
The cheapest solution**

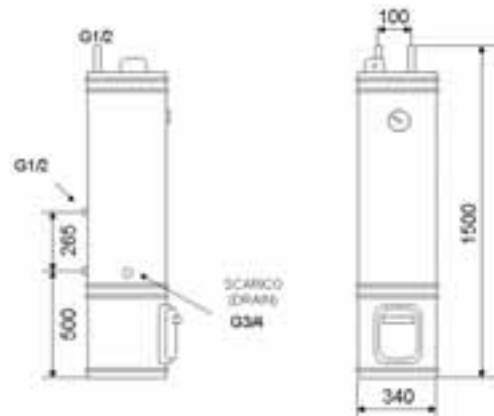

Model	Power watt	Tension volts	Max pressure bar	Class of insulation	Protection against humidity	Heating time 50°C			
L	1200	230	8	I	IPX4	70'	G 1/2	G 3/4	-
L-E	1200	230	8	I	IPX4	70'	G 1/2	G 3/4	-
L-TE	1200	230	8	I	IPX4	70'	G 1/2	G 3/4	mq.0,26

model	code	barcode	description
2 YEARS GUARANTEE			
L 80	SL0080C2V	8023945 360222	wood
L-E 80	SX0080C2V	8023945 380220	wood-electric
L-TE 80	SZ0080C2V	8023945 370221	wood-electric-indirect



THERMOMETER

CODE	description
XTERMO	thermometer
	thermometer for B-14
	thermometer for C-65



SCREW HEATING ELEMENT

CODE	description
XRES1200PA	1200 W 230 V
XRES1500PA	1500 W 230 V
XRESLEG	1200 W legna
XRES2000220PA	2000 W 230 V
	3000 W Trifase



FLANGE HEATING ELEMENT

CODE	description
XRES1500PA	1500 W 230 v (5 lt)
XRES1200PAFL	1200 W 230 V
XRES1500PAFL	1500 W 230 V
XRESCF2500PA	2500 W 230 V
XRESCF2000PA	2000 W 230 V



THERMOSTAT

CODE	description
XTERRTS300	double safety thermostat 16A
XTERB450	thermostat 16a
XLAMP	signal lamp



BULB THERMOSTAT

CODE	description
XTERMCAPIL	bulb thermostat
XSICCAP	bulb safety device



SAFETY VALVE

CODE	description
XVA1/2	1/2'
XVA3/4	3/4'
XVALE1/2	1/2' UNDERSINK - WOOD



FLANGE

CODE	description
YFLANGIA	flange for 30-200 L
YFLANGETTA	square flange for A5, Q12, B30



GASKETS

CODE	description
XGUARNGOMMA	round gaskets for flange (g.FL5/A)
XGUARNOR	o ring
XGUARNQUADRA	square gaskets for A5, Q12, B30



TRIPOD

CODE	description
XTRGR	big size(150/200 l)
XTRPI	little size (50/80/100 l)

MAGNESIUM ANODE ROD

CODE	description
	anode 21x60
	anode 21x100
	anode 21x150
	anode 26x200

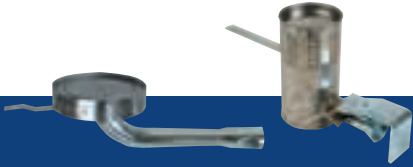

GAS BURNER

CODE	description
XBRUAC6	burner for 50-80-100-120 L
XBRUP5	burner for GIVP 150-200-300
XBRUP9	burner for GIVP 400-500

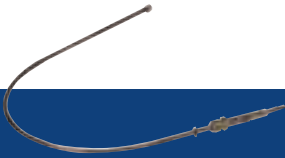

THERMOCOUPLES

CODE	description
XTERMO60	thermocouples cm 60
XTERMO80	thermocouples cm 80
XTERMO100	thermocouples cm 100
XTERMOGIVP	thermocouples GIVP



GAS VALVE



CODE	description
XVAGAACC	valve 610 AC2/DC50
XVAGAEURO	valveEurosit
XPIEZO	piezo lighting kit
XTERMOFU	smoke sensor device
XVAGAC3	valve AC3



www.bandini.it
e.mail: bandini@bandini.it



Bandini Scaldabagni S.r.l.
via Po, 11 - Poggibonsi - Siena (Italy)
Tel. 0577.936679 / 0577.933401
Fax 0577.983169